



Old Town SPORTSMAN

Old Town<sup>®</sup> SPORTSMAN<sup>™</sup>

ePDL+<sup>™</sup> Brake  
Replacement Kit

# SAFETY CONSIDERATIONS



## WARNING

Always have a personal flotation device and paddle with you when taking out a powered/pedal/paddle watercraft. Be especially careful when navigating in moving water, near dams, waterfalls, and/or hazardous water conditions.



## WARNING

You are responsible for the safe and prudent operation of your watercraft. We have designed your Old Town product to be an accurate and reliable tool that will enhance watercraft operation and improve your ability to catch fish. This product does not relieve you from the responsibility for safe operation of your watercraft. You must avoid hazards to navigation and always maintain a permanent watch so you can respond to situations as they develop. You must always be prepared to regain manual control of your watercraft. Learn to operate your Old Town product in an area free from hazards and obstacles.

**NOTICE:** The images in this document may not look the same as your product but your unit will function in a similar way.

# CONTENTS

## ⚠ CAUTION

Before getting started, please read all instructions thoroughly to prevent injury.

**ALWAYS WEAR SAFETY GLASSES WHEN HANDLING TOOLS AND EQUIPMENT.**

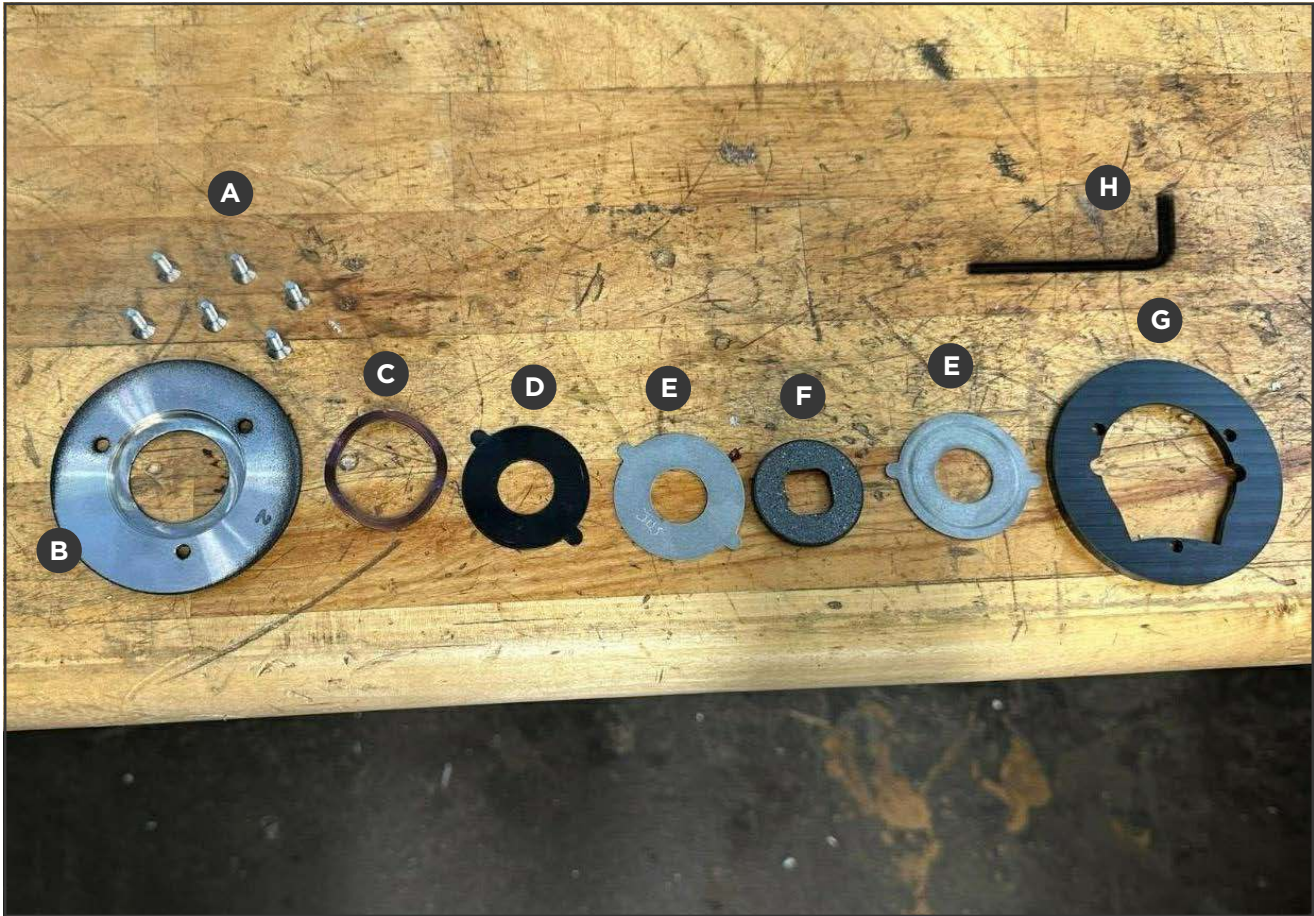

### PARTS

|    |                        |        |              |     |   |
|----|------------------------|--------|--------------|-----|---|
| A. | M4 X 12 Fasteners      | Part # | 01.1316.0219 | Qty | 6 |
| B. | Brake Cover            | Part # | 01.1316.0220 | Qty | 2 |
| C. | Wave Spring            | Part # | 01.1316.0214 | Qty | 2 |
| D. | Anti Squeak Shim       | Part # | 01.1316.0216 | Qty | 2 |
| E. | Friction Backing Plate | Part # | 01.1316.0215 | Qty | 4 |
| F. | Brake Pad              | Part # | 01.1316.0218 | Qty | 2 |
| G. | Brake Cover Spacer     | Part # | 01.1316.0217 | Qty | 2 |
| H. | 2.5mm Hex Key          | Part # | 01.1316.0402 | Qty | 1 |

### TOOLS REQUIRED

- Safety Glasses
- #2 Phillips Head Screwdriver
- 8mm Allen Wrench/Torque Wrench
- Spare Prop Pin

# INSTRUCTIONS

1

## REMOVING PEDAL ASSEMBLIES

Using an 8mm Allen wrench, remove the crank arm and pedal assembly from the drive and set aside.



2

## REMOVING OLD PEDAL STABILIZER

Orient your ePDL+™ Drive on it's side on a stable, flat working surface. Remove the three M4 x 12 fasteners from the brake cover using the 2.5mm hex key (H) provided.



3

Remove and discard the old pedal stabilizer components - the old brake cover, wave spring, anti-squeak shim, friction backing plate, brake pad, friction backing plate, and lastly the friction brake cover spacer.

4

## INSTALLING NEW PEDAL STABILIZER

Locate one of the new brake cover spacers (G) and place it over the crank arm shaft. Align the screw holes on the brake cover spacer with the drive and ensure the vents are in line with the drive.



# INSTRUCTIONS

5

If you have a spare prop pin, place it in one of the screw holes to align the drive with the brake cover spacer. This will help keep the assembly aligned during installation.



6

Locate one of the new backing plates (E) and install it over the crank shaft, aligning the tabs with the brake cover spacer.



7

Locate one of the new brake pads (F). With the chamfer side facing down, install it over the crank shaft, on top of the first backing plate.



8

Locate a second new backing plate (F) and install it over the crank shaft, on top of the brake pad. Align the tabs with the brake cover spacer.



# INSTRUCTIONS

9

Locate one of the new anti-squeak shims (D) and install it over the crank shaft, on top of the second backing plate.

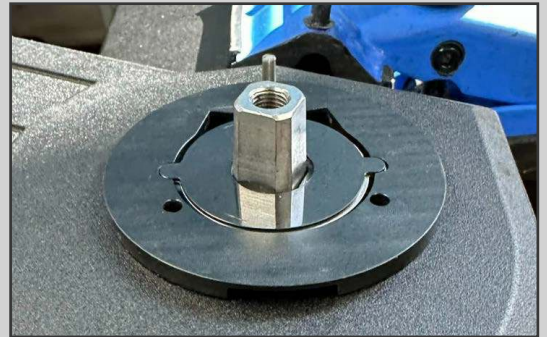

10

Locate one of the new wave springs (C) and install it over the crank shaft, on top of the anti-squeak shim.



11

Locate one of the new brake covers (B) and install it over the crank shaft, on top of the Smalley wave spring. Ensure the spring sits in the recess on the backside of the new brake cover and that the screw holes are aligned.

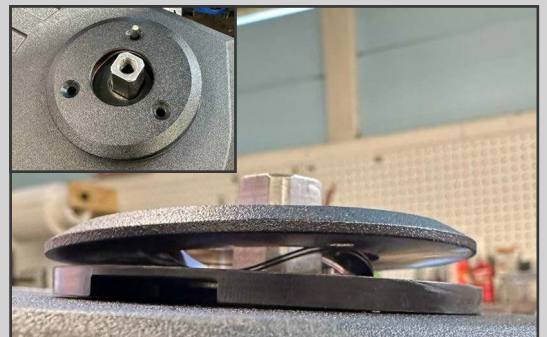

12

Locate three of the new M4 x 12 fasteners (A). With the prop pin still installed and aligning the assembly, push down on the brake cover and install the two fasteners. Remove the prop and install the third fastener.



# INSTRUCTIONS

13

## REINSTALLING PEDAL ASSEMBLIES

Locate the pedal assembly removed in Step 1 and reinstall using an 8mm Allen wrench. Check the backside of the crank arm to ensure the pedal assembly is installed on the correct side.



14

Repeat Step 13 for the other side. Ensure the second pedal assembly is oriented 180 degrees from the pedal assembly installed in Step 13.



15

Tighten both crank arms with a 8mm Allen torque wrench set to 30ft-lbs.

