

MEGA LIVE TARGETLOCK INSTALLATION GUIDE

532889-5EN_A



Thank You!

Thank you for choosing Humminbird®, the #1 name in marine electronics. Humminbird has built its reputation by designing and manufacturing top-quality, thoroughly reliable marine equipment. Your Humminbird accessory is designed for trouble-free use in even the harshest marine environment. In the unlikely event that your Humminbird does require repairs, we offer an exclusive Service Policy. For complete details, see the separate warranty card included with your unit. We encourage you to read this manual carefully in order to get the full benefit from all the features and applications of your Humminbird product.

Contact Humminbird Technical Support through our Help Center at <https://humminbird-help.johnsonoutdoors.com/hc/en-us>.

WARNING

This device should not be used as a navigational aid to prevent collision, grounding, boat damage, or personal injury. When the boat is moving, water depth may change too quickly to allow time for you to react. Always operate the boat at very slow speeds if you suspect shallow water or submerged objects.

The electronic chart in your Humminbird unit is an aid to navigation designed to facilitate the use of authorized government charts, not to replace them. Only official government charts and notices to mariners contain all of the current information needed for the safety of navigation, and the captain is responsible for their prudent use.

Humminbird is not responsible for the loss of data files (waypoints, routes, tracks, groups, recordings, etc.) that may occur due to direct or indirect damage to the unit's hardware or software. It is important to back up your fish finder's data files periodically. See your fish finder operations manual for details.

Disassembly and repair of this electronic unit should only be performed by authorized service personnel. Any modification of the serial number or attempt to repair the original equipment or accessories by unauthorized individuals will void the warranty.

WARNING

THIS PRODUCT CONTAINS A BUTTON BATTERY. If swallowed, a lithium button battery can cause severe or fatal injuries within 2 hours. Keep batteries out of reach of children. If you think batteries may have been swallowed or placed inside any part of the body, seek immediate medical attention.

WARNING

- **INGESTION HAZARD:** This product contains a button cell or coin battery.
- **DEATH** or serious injury can occur if ingested.
- A swallowed button cell or coin battery can cause **Internal Chemical Burns** in as little as **2 hours**.
- **KEEP** new and used batteries **OUT OF REACH of CHILDREN**.
- **Seek immediate medical attention** if a battery is suspected to be swallowed or inserted inside any part of the body.



1. This product contains a button/coin cell battery. Heed all safety considerations:
 - a) Remove and immediately recycle or dispose of used batteries according to local regulations and keep away from children. Do NOT dispose of batteries in household trash or incinerate.
 - b) Even used batteries may cause severe injury or death.
 - c) Call a local poison control center for treatment information.
 - d) The compatible battery type is CR2450.
 - e) The nominal battery voltage is 3.0 VDC.
 - f) Non-rechargeable batteries are not to be recharged.
 - g) Do not force discharge, recharge, disassemble, heat above (manufacturer's specified temperature rating of 60° C) or incinerate. Doing so may result in injury due to venting, leakage or explosion resulting in chemical burns.
2. This product contains a replaceable button/coin cell battery. Heed all safety considerations:
 - a) Ensure the batteries are installed correctly according to polarity (+ and -).
 - b) Do not mix old and new batteries, different brands or types of batteries, such as alkaline, carbon-zinc, or rechargeable batteries.
 - c) Remove and immediately recycle or dispose of batteries from equipment not used for an extended period of time according to local regulations.
 - d) Always completely secure the battery compartment. If the battery compartment does not close securely, stop using the product, remove the batteries, and keep them away from children.

NOTE

Some features discussed in this manual require a separate purchase. Every effort has been made to clearly identify those features. Please read the manual carefully in order to understand the full capabilities of your model.

The illustrations in this manual may not look the same as your product, but your unit will function in a similar way.

To purchase accessories, visit our Web site at **[humminbird.johnsonoutdoors.com](https://humminbird-johnsonoutdoors.com)** or Contact Humminbird Technical Support through our Help Center at **<https://humminbird-help.johnsonoutdoors.com/hc/en-us>**.

The procedures and features described in this manual are subject to change without notice. This manual was written in English and may have been translated to another language. Humminbird is not responsible for incorrect translations or discrepancies between documents.

Product specifications and features are subject to change without notice.

Humminbird verifies maximum stated depth in saltwater conditions, however actual depth performance may vary due to transducer installation, water type, thermal layers, bottom composition, and slope.

APEX™, Humminbird®, MEGA 360 Imaging™, MEGA Live 2 Imaging™, Minn Kota®, One-Boat Network®, QUEST™, SOLIX®, TargetLock™, Ultrex™, and XPLORE™ are trademarked by or registered trademarks of Johnson Outdoors Marine Electronics, Inc.

© 2025 Johnson Outdoors Marine Electronics, Inc. All rights reserved.

Table of Contents

Introduction	1
Compatibility.....	1
Supplies.....	2
Update Software	3
Software Requirements.....	3
Check the Current Software Version	3
Update Fish Finder Software with an SD Card	4
Update Accessory Software with an SD Card	4
Update Software with the One-Boat Network App	5
Install the MEGA Live TargetLock	7
1. Prepare for Installation	8
2. Install the Mounting Plate	9
A. MEGA Live TargetLock Mounting Plate	9
B. MEGA Live TargetLock Dual Mounting Plate (<i>for use with MEGA 360</i>).....	11
3. Install the Control Box.....	13
4. Install the Landscape Mode Mount	15
5. Route the Transducer Cables	18
6. Test the MEGA Live 2 Views.....	20
7. Connect the Shaft Assembly to the Mounting Plate	22
8. Install the MEGA Live TargetLock Heading Sensor	23
9. Adjust the Transducer Height.....	25
10. Reinstall the Motor Stabilizer.....	27
Install the MEGA Live TargetLock Foot Pedal	28
Install a MEGA 360 (separate purchase)	30
1. Prepare for Installation	30
2. Assemble the MEGA 360 Mount	31
3. Install the Pod.....	33
4. Adjust the Pod Height.....	34
5. Install the Collar Clamp	36

Table of Contents

Route the Cables and Connect Power	38
1. Route the MEGA Live 2 Power, Ethernet and Heading Sensor Cables	38
2. Route the MEGA Live TargetLock Control Box Cables	40
3. Route the MEGA 360 Cables (<i>separate purchase</i>)	43
4. Connect Power	44
Set Up the Fish Finder	46
1. Confirm Connections	46
2. Set Up MEGA Live 2 Imaging on the Fish Finder	48
3. Test MEGA Live 2 Imaging on the Fish Finder	49
4. Pair the TargetLock Heading Sensor to the Fish Finder	53
5. Calibrate Your MEGA Live TargetLock	53
6. Pair the Foot Pedal to the Fish Finder	54
7. Pair the TargetLock Remote to the Fish Finder	55
8. Set Up the Network	55
Power Off	56
Stowing and Traveling	56
Maintenance	57
Fish Finder Maintenance	57
Transducer Maintenance	58
MEGA Live 2 Imaging Maintenance	58
Replace the Foot Pedal Battery	58
Replace the Remote Battery	60
Troubleshooting	62
Fishing System Doesn't Power Up	62
Finding the Cause of Noise	63
Specifications	64
Contact Humminbird	68

Introduction

This manual will guide you through the following installation requirements for the MEGA Live TargetLock:

- Installing the Transducer and Foot Pedal
- Connecting to the Fish Finder and Power
- Testing the Installation
- Powering Off

Before proceeding with this installation, the Humminbird fish finder and Minn Kota® Ultrex™ or Ultrex QUEST™ trolling motor should be installed. The MEGA Live 2 Imaging transducer can be connected directly to the fish finder or to a Humminbird Ethernet Switch (optional, separate purchase required) for networking. See the Ethernet Switch installation instructions to install the Ethernet Switch.

Compatibility

Fish Finders: MEGA Live 2 is compatible with all APEX™ and XPLORE™ Series fish finders, and SOLIX® G3 fish finders. TargetLock can be mounted on Minn Kota Ultrex and Ultrex QUEST trolling motors.

Minn Kota Trolling Motor	Humminbird Fish Finder
Minn Kota Ultrex Minn Kota Ultrex QUEST	APEX Series: All models XPLORE Series: All models SOLIX Series: G3 models

Cables: Your MEGA Live 2 Imaging transducer comes with the cables required to connect directly to your APEX, XPLORE or SOLIX fish finder. In addition to the cables permanently attached to the transducer, this includes two extension cables (a 10' MEGA Live power cable and a 20' Ethernet cable) to allow for quick-disconnect.

NOTE

An ethernet switch (separate purchase required) can be used to connect your MEGA Live 2 Imaging transducer to multiple fish finders. To purchase accessories for your fish finders, visit our Web site at humminbird.johnsonoutdoors.com or Contact Humminbird Technical Support through our Help Center at <https://humminbird-help.johnsonoutdoors.com/hc/en-us>.

Accessories: A dual mount plate (separate purchase), is required to use a MEGA 360 Imaging™ transducer with your TargetLock.

For the most current list of compatible accessories, visit our Web site at humminbird.johnsonoutdoors.com.

Supplies

In addition to the hardware included with your accessory, you will need the following supplies:

- 5A slow-blow fuse
- Philips head screwdriver
- 3/8 wrench or socket
- 1/2 wrench or socket
- Cable ties
- Minn Kota trolling motor Stabilizer Kit (included with each Minn Kota trolling motor or available as a separately purchased accessory)
- 1 Amp fuse (needed for MEGA 360 installation only)
- Allen wrench (needed for MEGA 360 installation only)

Switch (optional): If you do not have a main switch or fuse panel available on your boat to connect power, you will need to purchase a battery switch. See ***Route the Cables and Connect Power, Section 4: Connect Power*** for more information.

Update Software

Your fish finder model may need a software update to work with the MEGA Live 2 transducer. We recommend that you read the following section completely before starting any software updates.

Software Requirements

- APEX/XPLORE/SOLIX G3 Series: 5.0 and later

Check the Current Software Version

It is helpful to review the software version number that is currently installed on the fish finder and each accessory.

1. Press the HOME key.
2. Select Settings.
3. Select System.
4. Select System Info.

Review the software version number listed for the fish finder.

5. Tap X, and select Network Info.
6. The Network Info dialog box shows a section for each device connected to the network. Scroll to MEGA Live 2 to note the software version number listed.

Update Fish Finder Software with an SD Card

You will need an SD or microSD card (depending on your fish finder model).

CAUTION

Humminbird is not responsible for the loss of data files (waypoints, routes, tracks, groups, snapshots, recordings, etc.) that may occur due to direct or indirect damage to the unit's hardware or software.

1. Install a formatted SD or microSD card into the computer card slot.
2. Go to **humminbird.johnsonoutdoors.com**, and click Support > Software Updates.
3. Click on your fish finder model. The available software updates are listed as downloads under each product. Confirm the file name is for your fish finder model.
 - Read the notices and instructions, and select Download.
 - Follow the on-screen prompts to save the software file to the SD or microSD card.
4. Power on your Humminbird fish finder. Start **Normal** mode.
5. Insert the SD or microSD card (with the software file) into the fish finder card slot.
6. Follow the on-screen prompts to update the fish finder software.

The software can be installed at a later time by using the Software Updates tool.
7. When the software update is complete, remove the SD or microSD card from the fish finder card slot.

Update Accessory Software with an SD Card

You will need an SD or microSD card (depending on your fish finder model).

1. Install a formatted SD or microSD card into the computer card slot.
2. Go to **humminbird.johnsonoutdoors.com**, and click Support > Software Updates.
3. Scroll down to Accessories and Mapping. The available software updates are listed as downloads under each accessory product. Confirm your fish finder model is listed in the software description.
 - Read the notices and instructions, and select Download.
 - Follow the on-screen prompts to save the software file to the SD or microSD card.

4. Power on your Humminbird fish finder. Start **Normal** mode.
5. Insert the SD or microSD card (with the software file) into the fish finder card slot.
6. Select Tools > Software Updates. Scroll to MEGA Live 2 on the Accessories list. Confirm that the most current software version is selected from the list, and select Install Now.
7. When the software update is complete, remove the SD or microSD card from the fish finder card slot.

Update Software with the One-Boat Network App

You can use the One-boat Network App to download and push software updates directly to your Humminbird fish finder or accessory.

NOTE

It is important to install the latest software update on your fish finder to enable all One-Boat Network features. For the latest software update, visit our Web site at humminbird.johnsonoutdoors.com.

You must first download the One-Boat Network App and pair your mobile device to your fish finder. See the ***One-Boat Network App Operations Guide*** for more information.

Update Humminbird Software

1. Open the One-Boat Network App on your mobile device.
2. From the Home screen, tap Network + Updates.
3. Under Humminbird Units, tap Download Update. The download progress is displayed on the screen.

You can also tap the More Options icon (...) next to the device you want to update, and then tap Download Update.

NOTE

Your update may take several minutes to download. You may close the app while you wait for the download to complete.

4. Once your download is complete, tap Transfer Software.

You can also tap the More Options icon (...) again, and then tap Transfer Software or Delete Software.

5. Confirm the estimated transfer time.
6. Tap the radial button to select where to upload the software update (Internal Storage, SD Card 1 or SD Card 2).

NOTE

You cannot download software updates to an SD or microSD card with CoastMaster or LakeMaster charts saved to it.

7. Tap Start Transfer (Apple iOS) or Transfer (Google Android).
The upload progress is displayed under the selected unit in the One-Boat Network App and in the System Status view on the fish finder.
8. Follow the on-screen prompts on the fish finder to complete the software installation.

Update Accessory Software

1. Open the One-Boat Network App on your mobile device.
2. Tap Network + Updates.
3. Tap Download Update next to the device you want to update. The download progress is displayed on the screen.
4. Tap Transfer Software next to the selected device once the download is complete.

Install the MEGA Live TargetLock

Use the following instructions to install the MEGA Live TargetLock transducer on your Minn Kota Ultrex or Ultrex QUEST trolling motor. It is important to read the instructions completely and understand the mounting guidelines before you start the installation.

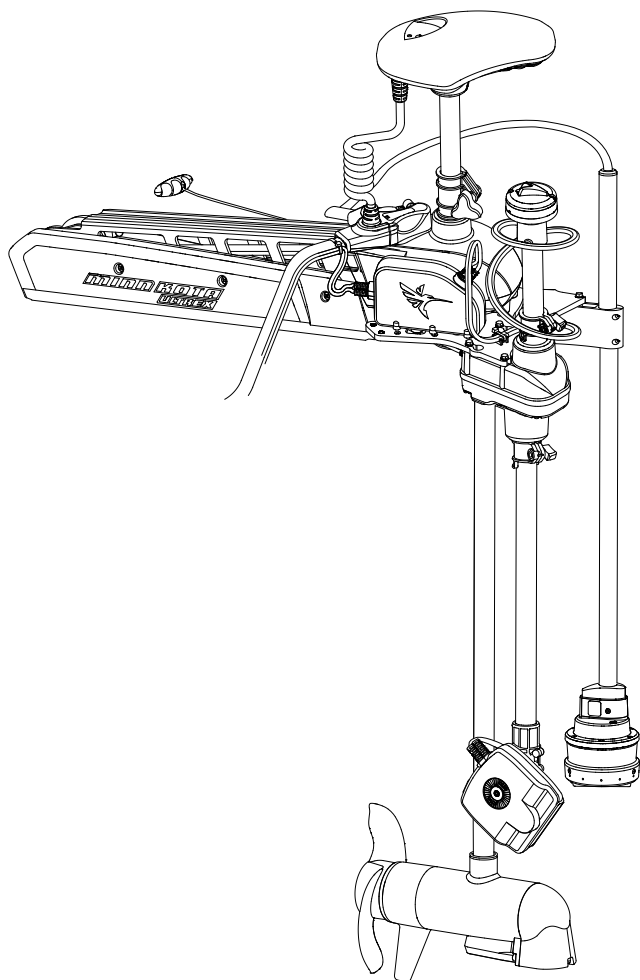

1. Prepare for Installation

1. The trolling motor should be in the fully retracted (flat) position on the boat deck for this installation.
2. Disconnect the motor from all sources of electrical power.
3. Test run the Ethernet cable from the chosen mounting location on the trolling motor to the fish finder or ethernet switch. Test run the power cable from the chosen mounting location on the trolling motor to the main switch or fuse panel.

It is important to consider the following:

- The MEGA Live TargetLock is powered separately from the fish finder. It must be connected to a switch where it can be powered on when the boat is underway and powered off when it is docked.
 - The cables should be routed through an established routing system on the boat, in an area with minimal interference, without sharp edges, obstacles, or obstructions that may damage the cables.
 - The cables will move with the trolling motor when it is deployed and retracted, so it is important to allow enough length for movement.
4. Determine if you must uninstall and reinstall your trolling motor stabilizer. You will need to uninstall and reinstall the stabilizer if:
 - You are installing your MEGA Live TargetLock on the inboard side of your trolling motor.

OR

- You are installing the dual mount accessory (for MEGA Live TargetLock and MEGA 360 installation, separate purchase required).

You will reinstall the stabilizer after you have completed installation of your MEGA Live TargetLock. See the installation guide that was included with your trolling motor or visit **www.minnkota.johnsonoutdoors.com** for installation instructions.

NOTE

A trolling motor stabilizer included with each Minn Kota trolling motor or available as a separately purchased accessory) is required to support your MEGA Live Targetlock. It must be installed before taking your MEGA Live TargetLock on the water.

5. With the trolling motor deployed, the transducer has the following installation requirements:
 - The transducer should not have anything obstructing the 'view' of the beams. If possible, move anything to the sides and below the transducer that might obstruct the sight line of the beams.

2. Install the Mounting Plate

Proceed to the installation section for the type of mounting plate you will be using:

A. MEGA Live TargetLock Mounting Plate (for use with MEGA Live TargetLock only)

OR

B. MEGA Live TargetLock Dual Mounting Plate (for use with MEGA Live TargetLock and MEGA 360, separate purchase required)

A. MEGA Live 2 Mounting Plate (for MEGA Live only installation)

The plate can be mounted on the left or right side of the trolling motor.

1. Align the plate below the BowGuard. Line up the holes on the plate with the threaded holes on the BowGuard.
2. Install the four (4) included 5/16-18 x 1" bolts through the plate and into the BowGuard. Hand-tighten using a 1/2" nut driver or socket wrench until secure (see the illustrations *Installing the Mounting Plate on an Ultrex* and *Installing the Mounting Plate on an Ultrex QUEST*). Hand-tighten only!

NOTE

For installation on an Ultrex QUEST trolling motor, use the two (2) included spacers between the plate and the motor on the upper screws (see the illustration *Installing the Mounting Plate on an Ultrex QUEST*).

Installing the Mounting Plate on an Ultrex

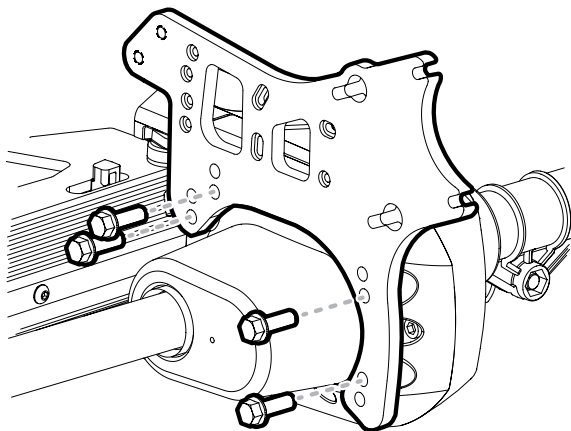

Installing the Mounting Plate on an Ultrex QUEST

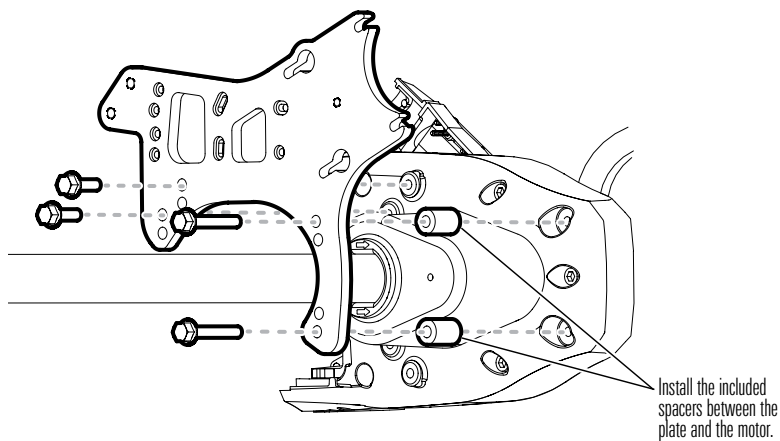

B. MEGA Live TargetLock Dual Mounting Plate

(for MEGA Live TargetLock and MEGA 360 installation)

The dual mounting plate (separate purchase) will allow you to install your MEGA Live TargetLock on one side of your trolling motor and your MEGA 360 on the other.

1. If you have a trolling motor stabilizer installed, you will first need to uninstall it. You will reinstall it after you have completed installation of your MEGA Live 2. See the installation guide that was included with your trolling motor or visit www.minnkota.johnsonoutdoors.com for instructions.
2. Align the plate below the BowGuard. Line up the holes on the plate with the threaded holes on the BowGuard.
3. Install the six (6) included 5/16-18 x 1" bolts through the plate and into the BowGuard. Hand-tighten using a 1/2" nut driver or socket wrench until secure (see the illustrations *Installing the Dual Mounting Plate on an Ultrex* and *Installing the Dual Mounting Plate on an Ultrex QUEST*). Hand-tighten only!

NOTE

For installation on an Ultrex QUEST trolling motor, use the two (2) included spacers between the plate and the motor on the upper screws (see the illustration *Installing the Mounting Plate on an Ultrex QUEST*).

Installing the Dual Mounting Plate on an Ultrex

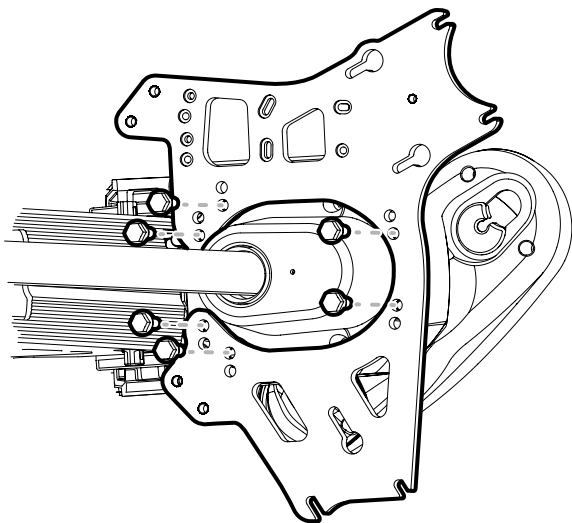

Installing the Dual Mounting Plate on an Ultrex QUEST

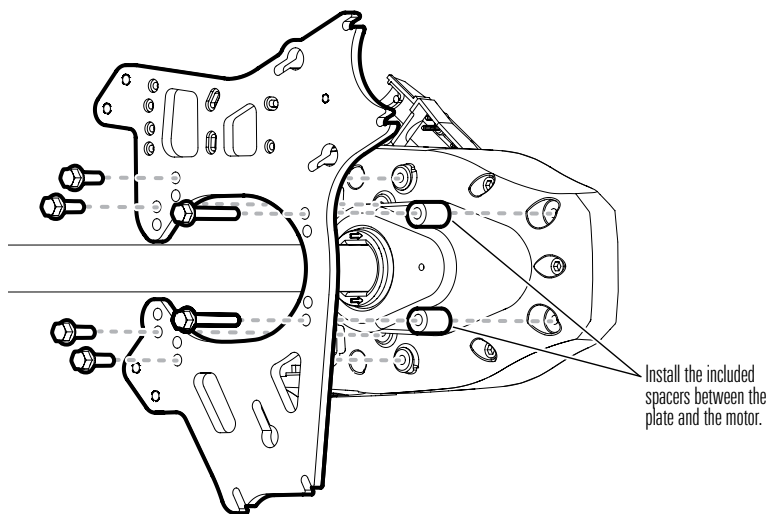

3. Install the Control Box

1. Align the control box over the mounting plate with the power connector inside the larger cutout in the mounting plate (see the illustrations *Installing the Control Box on an Ultrex* and *Installing the Control Box on an Ultrex QUEST*).
2. Install the six (6) included 8-32 screws through the plate and into the control box using the provided 9/64" Allen wrench. **Hand tighten only!**

Installing the Control Box on an Ultrex

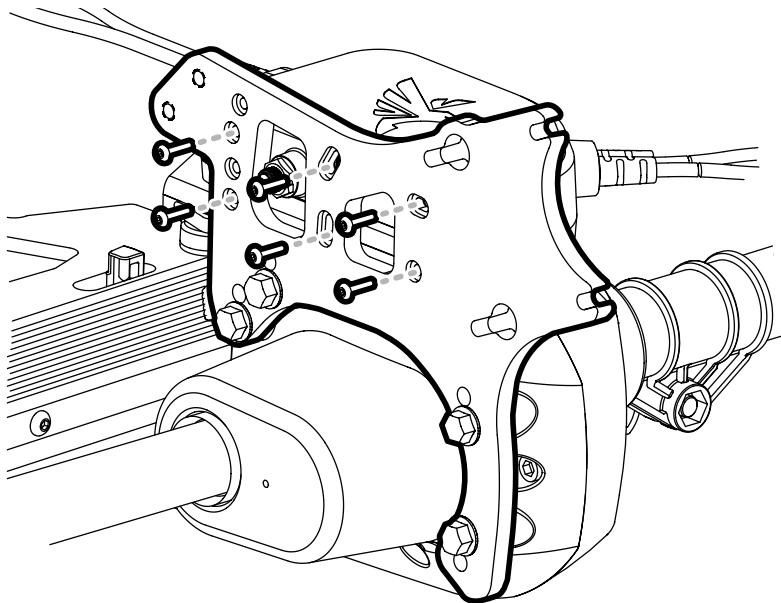

Installing the Control Box on an Ultrex QUEST

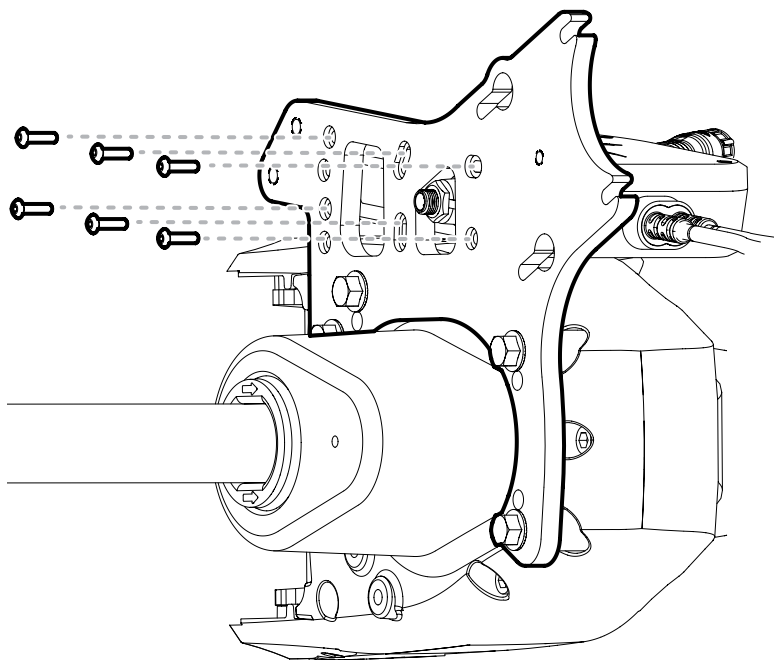

4. Install the Landscape Mode Mount

Use the following instructions to install the Landscape Mode mount onto the shaft mount and the transducer.

1. The Landscape Mode mount should be open for this step of the installation. Unlock the mount by pressing down on the single release button and pulling the mount open. It will relock automatically once fully opened.

Landscape Mode Mount

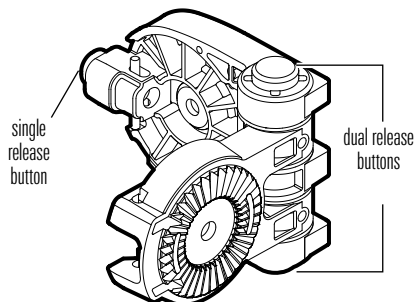

2. Connect the MEGA Live 2 Adapter to the Landscape Mode mount. The ratchets on the Landscape Mode mount hinge and the adapter are keyed to ensure correct alignment.
3. With the Landscape Mode mount hinge perpendicular to the shaft, connect the Landscape Mode mount to the shaft mount (see the illustration ***Connecting the Landscape Mode Mount to the Adapter and Shaft Mount***).

The ratchets on the Landscape Mode mount hinge and the shaft mount are keyed to ensure correct alignment.

4. Secure the Landscape Mode mount to the shaft mount with one of the included lock washers and the 1 1/8" screw, using the provided hex bit. Hand tighten the screw until the lock washer is fully compressed (see the illustration ***Compressing the Lock Washer***), and then tighten an additional 1/4 turn. **Hand tighten only!**

⚠ CAUTION

The screw and lock washer MUST be fully tightened. Failure to do so may result in the transducer detaching from the Landscape Mode mount in the water.

**Connecting the Landscape Mode
Mount to the Adapter and Shaft Mount**

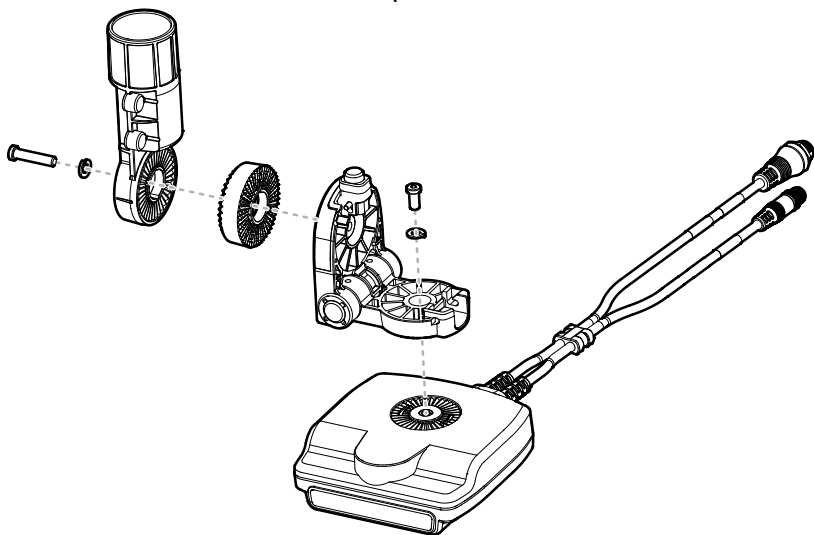

5. Secure the Landscape Mode mount to the transducer with one of the included lock washers and 1/4-28 screw, using the provided hex bit. Hand tighten until the lock washer is fully compressed (see the illustration Compressing the Lock Washer), and then tighten an additional 1/4 turn. **Hand tighten only!**

⚠ CAUTION

The screw and lock washer MUST be fully tightened. Failure to do so may result in the transducer detaching from the Landscape Mode mount in the water.

Compressing the Lock Washer

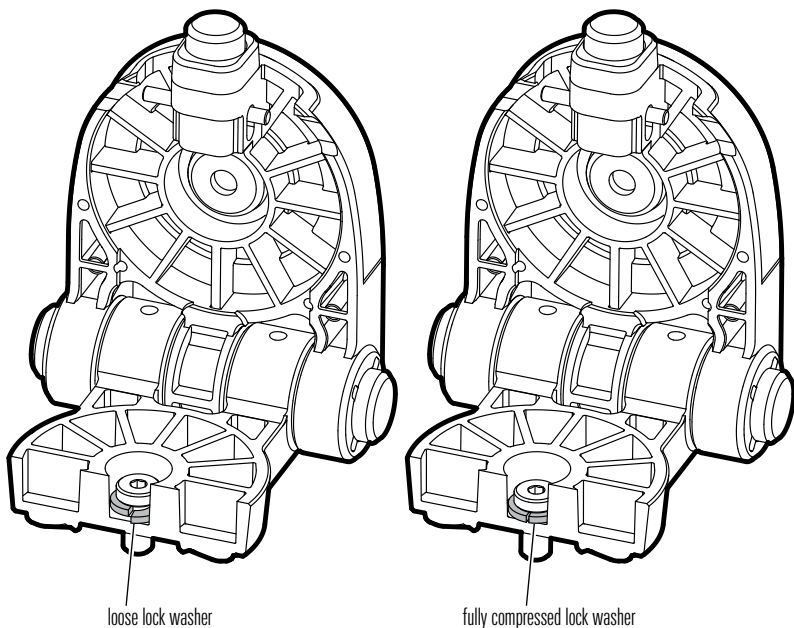

5. Route the Transducer Cables

1. Feed the transducer cables through the shaft until the last molded anchor point has just passed the shaft mount (see the illustration *Routing the Cables*).

Routing the Cables

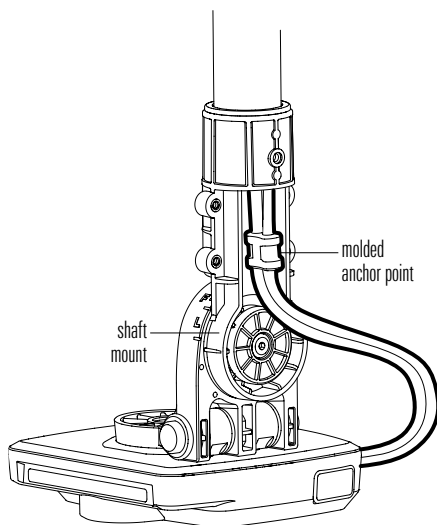

2. Connect the cable cover to the shaft mount. The last molded anchor point is keyed to fit into the base of the cable cover (see the illustration *Connecting the Cable Cover*).
3. Secure the cable cover with the four (4) included 8-32 screws, using the provided 9/64" Allen wrench. **Hand tighten only!**

Connecting the Cable Cover

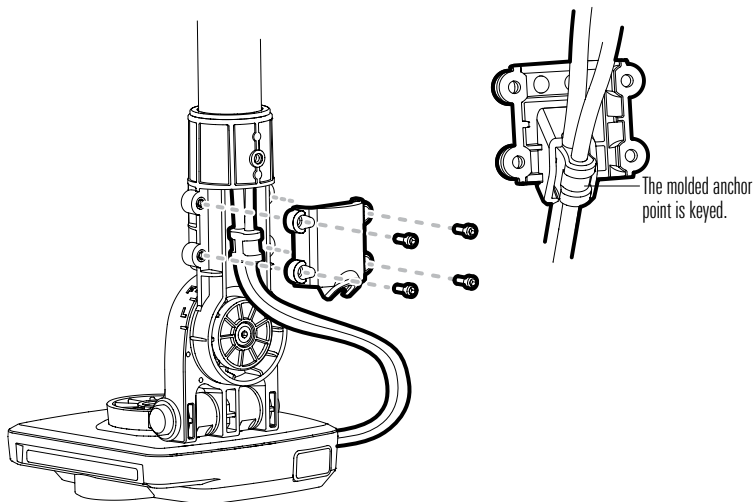

6. Test the MEGA Live 2 Views

1. Rotate the transducer by hand to test the Down, Forward and Landscape Mode views as illustrated in **MEGA Live 2 Views**. Your trolling motor mount includes guides to help you position the transducer correctly (see the illustration **MEGA Live 2 Mode Guides**).

To alternate between Down and Forward views, rotate the transducer on its mount using both hands.

To change from Down or Forward view to Landscape Mode, press the single release button on the hinge until the mount unlocks. Flip the transducer out until the hinge locks.

To adjust the Landscape Mode angle, rotate the transducer on its mount using both hands.

MEGA Live 2 Mode Guides

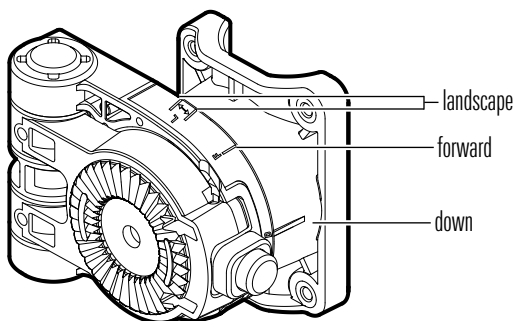

MEGA Live 2 Views

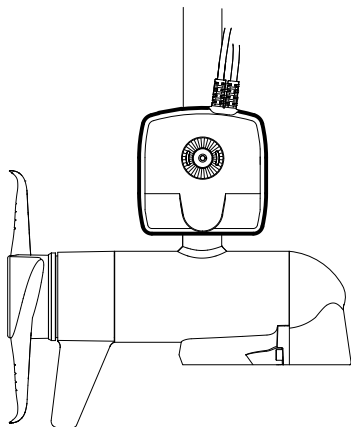

Down View

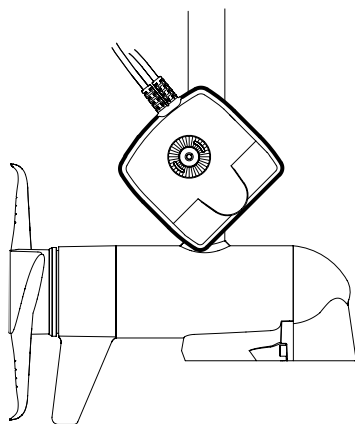

Forward View

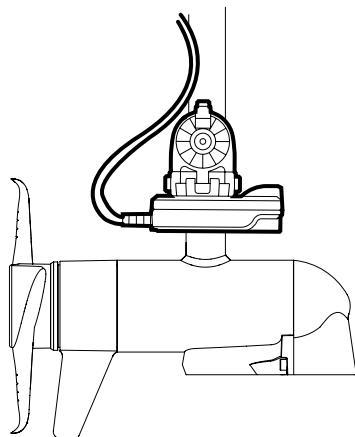

Landscape Mode

7. Connect the Shaft Assembly to the Mounting Plate

1. Install the (4) 1/4-20 x 1" screws into the threaded holes on the steering housing. Do not fully tighten.
2. Slide the bolts into the plate slots as shown in the illustration *Connecting the Steering Housing Assembly*.

Connecting the Steering Housing Assembly

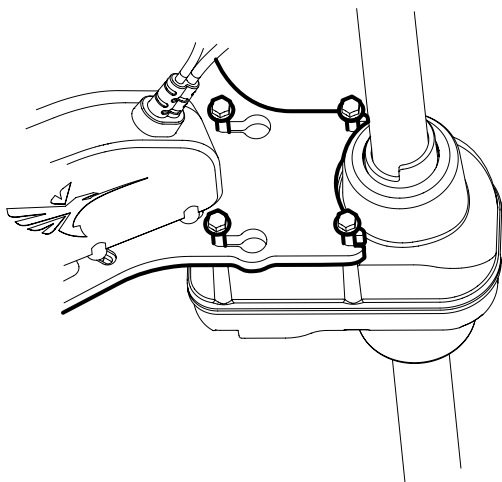

3. Hand-tighten the bolts using a 3/8" wrench. **Hand tighten only!**

8. Install the MEGA Live TargetLock Heading Sensor

1. Slide the heading collar over the cables and shaft and align the holes in the collar with the holes at the top of the shaft.

NOTE

Align the heading collar so that the raised section faces away from the MEGA Live 2 transducer's pinging element (instead of towards it) to ensure the arrow on the TargetLock heading sensor will point in the same direction as the MEGA Live 2.

2. Feed the TargetLock heading sensor cable through the heading mount and position the sensor on the mount so that the arrow on the sensor points away from the gap in the mount.
3. With the gap in the mount aligned with the raised section of the heading collar, slide the mount over the transducer cables and collar so that the transducer cables and TargetLock heading sensor cable exit the mount through the gap.

NOTE

The cables should be aligned so that the heading sensor cables are stacked on top of the MEGA Live 2 power and ethernet cables.

4. Secure the heading collar and mount to the shaft with the included #8-32x2 screw and hex key (see the illustration ***Connecting the Heading Collar and Mount***).

NOTE

You may need to adjust the positioning of the cables to make room for the screw.

5. Secure the TargetLock heading sensor to the mount with the included two (2) #8-32x7/8 screws.

Connecting the Heading Collar and Mount

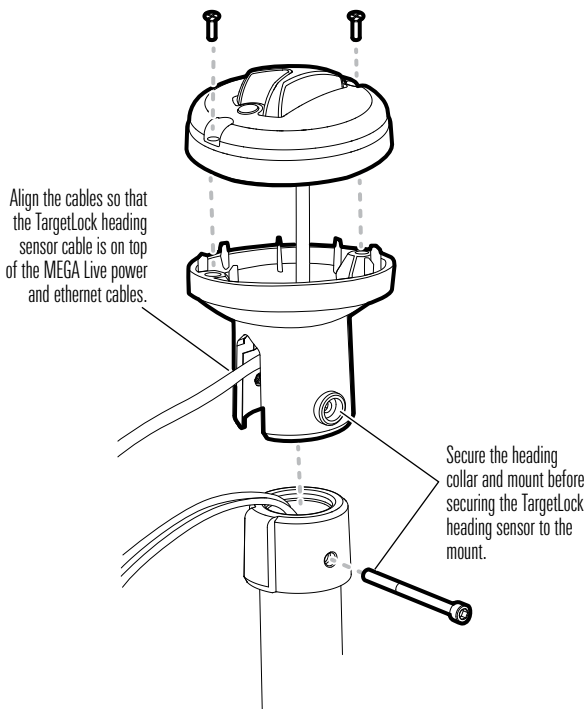

6. Slide the provided sleeving over all three cables, pushing one end into the opening of the mount.
7. Adjust the sleeving until it is smooth and then secure both ends using one of the included cable tie just outside of the TargetLock heading sensor mount and a second cable tie around the body of the transducer ethernet connector.
8. Fold excess sleeving back on itself and secure it with cable ties.

NOTE

If you do not plan to remove your unit frequently, you may also use the excess sleeving to cover all of the connectors.

9. Adjust the Transducer Height

1. Loosen the depth collar knobs and adjust the transducer shaft up or down so that it meets the following height requirements in all three views (see *Install the MEGA Live TargetLock, Section 6: Test the MEGA Live 2 Views*):
 - The transducer must be mounted approximately 6" (152.4 mm) below the waterline.
 - The transducer must be mounted at least 1" (25.4 mm) off the tip of the propeller.

WARNING

DO NOT INSTALL THE TRANSDUCER TOO CLOSE TO THE PROPELLER. If the transducer is installed too close to the propeller, it will be damaged. Ensure there is at least 1" of clearance between the transducer and the propeller. MEGA Live 2 damage caused by the transducer being installed too close to the trolling motor's propeller is NOT covered by the product warranty.

NOTE

It may be necessary to readjust your transducer height prior to stowing and transport. See *Stowing and Traveling with the MEGA Live 2 Transducer* for more information.

2. Slide the bottom depth collar to the desired position, and tighten the knob to secure the depth collar in place so the transducer shaft is fully secure and won't drop during operation.
3. Slide the top depth collar down to secure the transducer shaft to the desired height, and tighten the knob to secure the depth collar in place.

Securing the Depth Collars

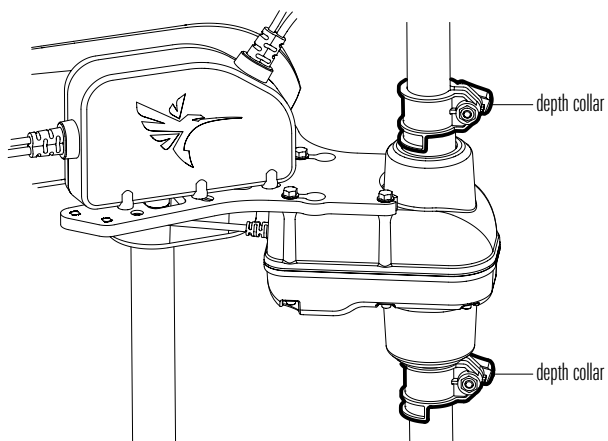

10. Reinstall the Motor Stabilizer

1. If you removed your motor stabilizer prior to installing your Mega Live 2 inboard, reinstall it now through the MEGA Live TargetLock plate (see the illustration *Reinstalling the Motor Stabilizer*) using the provided 5/16" screws with locking washers. It may be necessary to shorten your motor stabilizer. See the installation guide included with your trolling motor or visit www.minnkota.com for more information.

NOTE

A trolling motor stabilizer (included with each Minn Kota trolling motor or available as a separately purchased accessory) is required to support your MEGA Live Targetlock. It **must** be installed before taking your MEGA Live TargetLock on the water.

Reinstalling the Motor Stabilizer

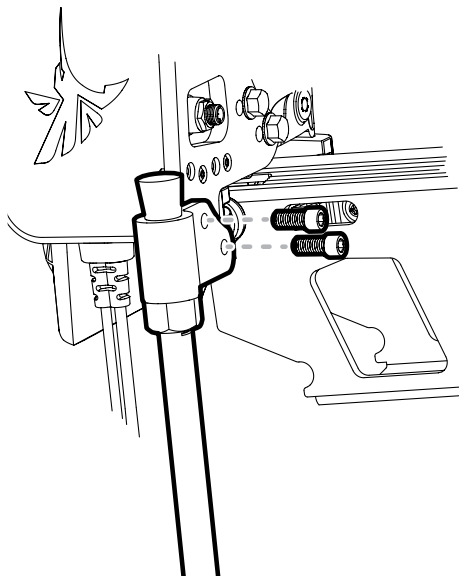

Install the MEGA Live TargetLock Foot Pedal

Before mounting your MEGA Live TargetLock foot pedal, please give consideration to the following:

- Examine your boat to ensure that you will not drill into any obstructions and that the hardware will be accessible for assembly.
 - Make sure the area under the mounting location is flat, clear to drill holes and that the installation hardware will not damage existing components below the mounting surface. It may be necessary to shim or modify the mounting surface under the mounting location to create a flat area for the foot pedal to be mounted.
 - Mount the foot pedal in an area that has a clear line of communication with your Humminbird.
 - Mount the foot pedal in an area where it will not become a tripping hazard.
1. Once you have selected a mounting location for your foot pedal, remove the foot pedal from the base by squeezing the tabs on both sides of the foot pedal and pulling the pedal and base apart.

Separating the Foot Pedal and Base

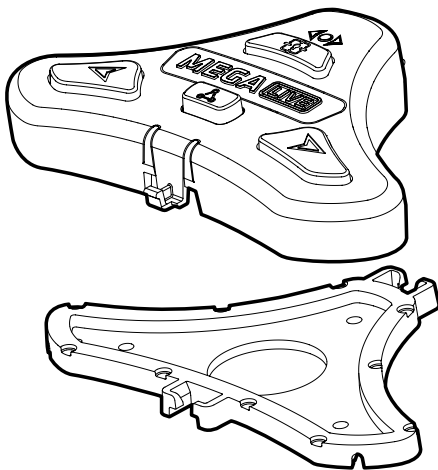

2. Position the base at the selected location and mark the mounting holes with a pencil or similar marking tool.

NOTE

The base has three mounting holes that are used to secure it to the boat. The bottom side of the base has three pads around the mounting holes. These pads should be placed facing down when the base is installed.

3. Place one of the three (3) provided #8 screws in each of the mounting holes of the base. Make sure the mounting holes still line up with the marked locations and then use a drill with a #2 Phillips driving bit to secure the base to the deck of the boat. Do not overtighten.

Securing the Base to the Deck

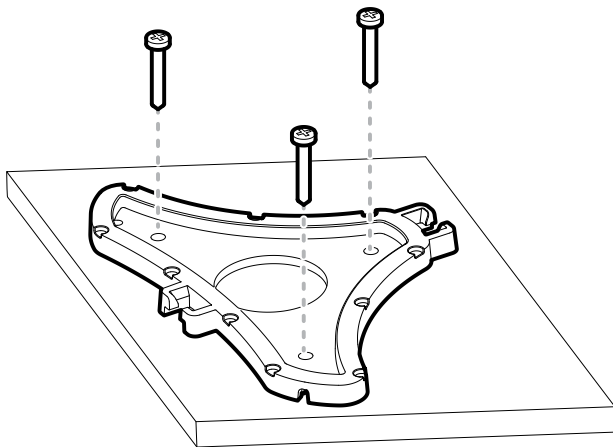

4. Once the base is installed, reattach the foot pedal to the base. Make sure the tabs on the pedal click into place and that the pedal is fully seated on the deck of the boat.

Install a MEGA 360 (separate purchase, for use with the dual mounting plate)

Use the following instructions to install the MEGA 360 Imaging transducer (separate purchase required) on your Minn Kota Ultrex or Ultrex QUEST trolling motor. It is important to read the instructions completely and understand the mounting guidelines before you start the installation.

NOTE

The dual mounting plate (separate purchase) is required for this installation. See *Install the MEGA Live TargetLock, Section 2B: MEGA Live TargetLock Dual Mounting Plate* for mounting plate installation instructions.

1. Prepare for Installation

1. The trolling motor should be in the fully retracted (flat) position on the boat deck for this installation.
2. Disconnect the motor from all sources of electrical power.
3. Test run the transducer cable from the chosen mounting location on the trolling motor to the fish finder. Test run the power cable from the chosen mounting location on the trolling motor to the main pedal or fuse panel.

It is important to consider the following:

- The MEGA 360 Imaging transducer pod is powered separately from the fish finder. It must be connected to a switch where it can be powered on when the boat is underway and powered off when it is docked.
 - The cables should be routed through an established routing system on the boat, in an area with minimal interference, without sharp edges, obstacles, or obstructions that may damage the cables.
 - The cables will move with the trolling motor when it is deployed and retracted, so it is important to allow enough length for movement.
4. With the trolling motor deployed, the transducer pod has the following installation requirements:
 - The transducer pod should not have anything obstructing the 'view' of the rotating beams (besides the trolling motor and shaft). If possible, move anything to the sides and below the pod that might obstruct the sight line of the rotating beams.

- The pod must be mounted at least 1" (25.4 mm) off the tip of the propeller.
- The pod should be submerged 6" (152.4 mm) below the waterline. The height may be adjusted, however, the pod must be mounted 1" (25.4 mm) off the tip of the propeller.

2. Assemble the MEGA 360 Mount

1. If your MEGA 360 will be mounted on the left side of the trolling motor, position the mount so the straight edge faces to the left as shown in the illustration.

Positioning the Mount for Installation on the Left Side of Trolling Motor

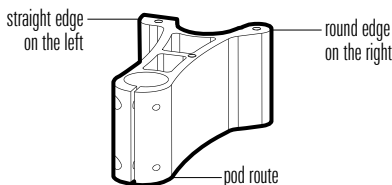

If your MEGA 360 will be mounted on the right side of the trolling motor, position the mount so the straight edge faces to the right as shown in the illustration.

Positioning the Mount for Installation on the Right Side of Trolling Motor

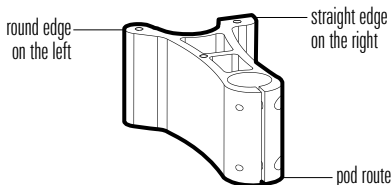

2. Install the (3) 1/4-20 x 1" screws into the threaded holes on the bracket as shown in the illustration. Do not fully tighten.

Installing the Screws onto the Mount

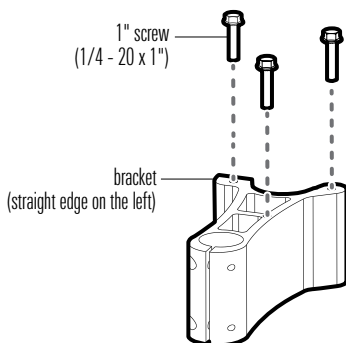

3. Align the left screw (left side installation) or right screw (right side installation) under the center hole of the dual mounting plate (see the illustration ***Securing the Mount and Plate***).
4. Slide the screw into the plate slot and then slide the other two screws into the outside slots on the plate.

Securing the Plate and Bracket

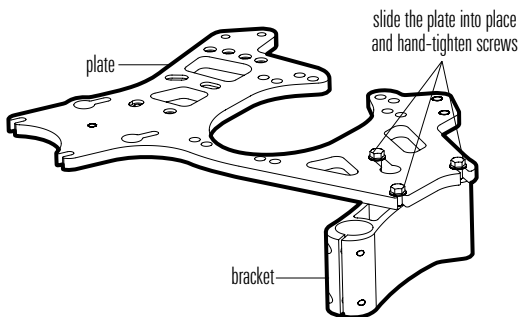

5. Hand-tighten the screws using a 3/8" nut driver or socket wrench. **Hand-tighten only!**

3. Install the Pod

1. Route the cables and up through the trolling motor mount and bracket.
2. Use an Allen wrench (not included) to install the (2) 10-32 x 9/16" socket bolts on the bracket where the pod shaft is installed.
3. Tighten the bolts so the pod shaft is fully secure and won't drop when it is deployed in the next step. **Hand-tighten only!**

Routing the Cables and Pod Shaft

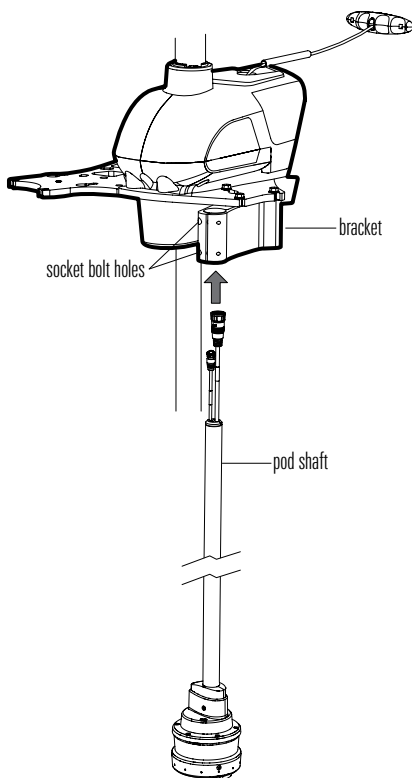

4. Adjust the Pod Height

1. Deploy the Trolling Motor.
2. Loosen the socket bolts on the mount where the pod shaft is installed. Adjust the pod shaft up or down, so it meets the following height requirements:
 - The pod must be mounted approximately 6" (152.4 mm) below the waterline.
 - The pod must be mounted at least 1" (25.4 mm) off the tip of the propeller.
 - The pod shaft needs to protrude at least 1" to 2" (25.4 mm to 50.8 mm) above the bracket when it is installed.

WARNING

DO NOT INSTALL THE POD TOO CLOSE TO THE PROPELLER. If the pod is installed too close to the propeller, it will be damaged. Ensure there is at least 1" of clearance between the pod and the propeller. MEGA 360 damage caused by the pod being installed too close to the trolling motor's propeller is NOT covered by the product warranty.

Adjusting the Pod Height (at least 1" from the tip of the propeller)

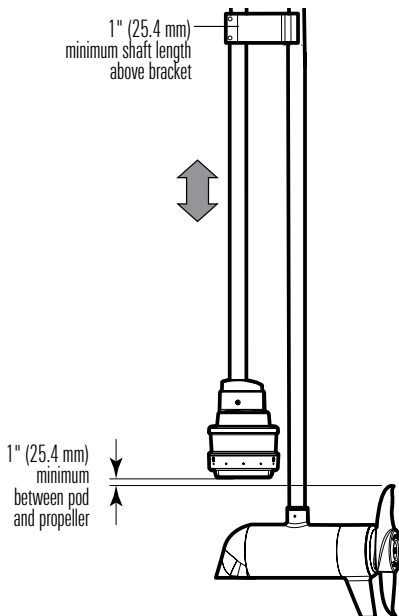

3. Turn the pod shaft until the rounded end of the transducer points in the direction of travel. The centerline of the transducer should be parallel with the centerline of the boat. See the illustration *Aligning the Transducer*.

Aligning the Transducer

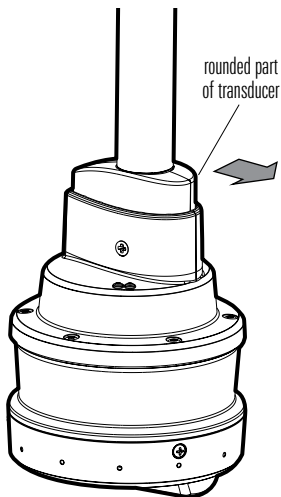

4. When the transducer position is finalized, hand-tighten the socket bolts equally and completely so the pod shaft is fully secure and won't drop or rotate during operation. Tighten each bolt an additional 1/4 or 1/2 turn. **Hand-tighten only!**

Hand-Tightening the Socket Bolts

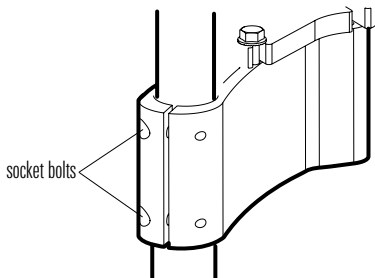

5. Install the Collar Clamp

After you have established the pod height is no closer than 1 inch from the tip of the propeller, install the collar clamp to prevent the trolling motor from hitting the transducer pod.

1. Select the appropriate collar clamp for the trolling motor. Use the 1.3" collar clamp for the Ultrex and the 1.5" collar clamp for the Ultrex QUEST.
2. Apply anti-seize to the end of each 1" socket bolt (1/4-20 x 1").
3. Install a 1" socket bolt (1/4-20 x 1") into the hole on 1 clamp half.
4. Place the bumper into the groove of the trolling motor shaft. Center one clamp half over the bumper as shown in the illustration.
5. Install the clamp (half), and hex nut (1/4-20) onto the trolling motor shaft as shown in the illustrations. Repeat on the other side.

Installing the Collar Clamp on the Ultrex

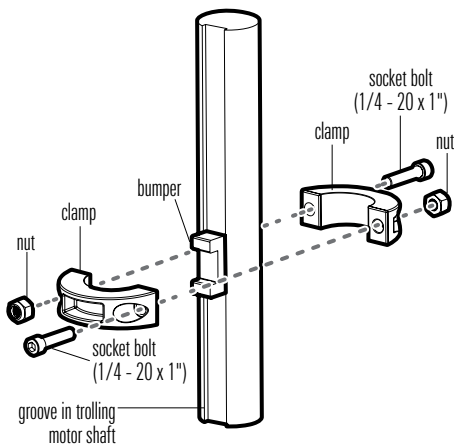

Installing the Collar Clamp on the Ultrex QUEST

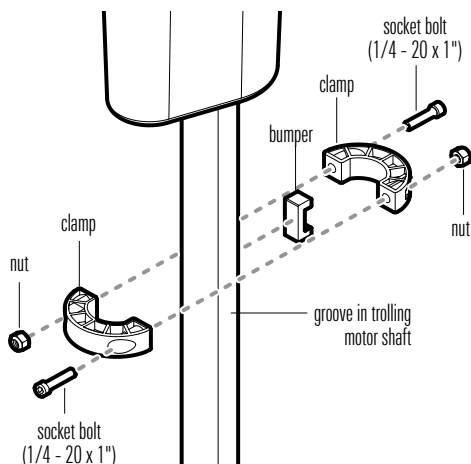

6. Use an Allen wrench (not included) to tighten the hardware just enough to keep the collar assembled.
7. Slide the collar up to the base of the BowGuard.
8. Use an Allen wrench (not included) to fully tighten the socket bolts until they are secure. **Hand-tighten only!**

Details: Tighten the socket bolts and collar clamp hardware evenly on both sides of the clamp until you feel them start to compress and secure, and then tighten each bolt an additional 1/4 to 1/2 turn.

CAUTION

The socket bolts must be tightened completely to prevent the trolling motor from potentially damaging the pod. **Hand-tighten only!**

Route the Cables and Connect Power

WARNING

The power source must be turned off before you proceed with this installation.

CAUTION

Do NOT route your MEGA Live TargetLock cables where they can be cut, ripped, or pulled by the trolling motor articulating, rotating, or during stow and deploy. Failure to correctly route your cables WILL result in damage to your control box. **Wires damaged by improper installation are NOT covered by the product warranty.**

Do NOT mount the cables where the connectors could be submerged in water or flooded. If cables are installed in a splash-prone area, it may be helpful to apply dielectric grease to the inside of the connectors to prevent corrosion. Dielectric grease can be purchased separately from a general hardware or automotive store.

NOTE

The cables should be routed through an established routing system on the boat, in an area with minimal interference. Inspect the selected route carefully to ensure that there are no sharp edges, obstacles, or obstructions that may damage the cables. **Avoid pinch points created by stowing or deploying the trolling motor.**

1. Route the MEGA Live 2 Power, Ethernet and Heading Sensor Cables

1. Loosely wrap the sleeved MEGA Live 2 power, Ethernet and TargetLock heading sensor cables exiting the TargetLock heading sensor mount around the upper end of the shaft. Leave sufficient slack in the cables to allow for full movement of the shaft during normal operation (see *Routing the Transducer and TargetLock Heading Sensor Cables*).

2. Connect the transducer and TargetLock heading sensor cables to the control box.

Ethernet: Insert the Ethernet Cable into the Ethernet port on the control box. Hand-tighten the screw nut.

Power: Insert the Power Cable into the Power port on the control box. Hand-tighten the screw nut.

TargetLock Heading sensor: Connect the TargetLock heading sensor cable to the heading sensor port on the control box. If there is excess cable, it can be fed back into the TargetLock heading sensor mount.

Hand-tightening the Screw Nut



The connectors are keyed to prevent reversed installation.

3. Secure the included zip tie mount to your mounting plate using the provided 1/4-20 x 3/8" screw (see illustration *Installing the Zip Tie Mount*).
4. Secure the cables to the zip tie mount on your mounting plate using one of the included zip ties (see the illustration *Securing the Cables to the Zip Tie Mount*).

Installing the Zip Tie Mount

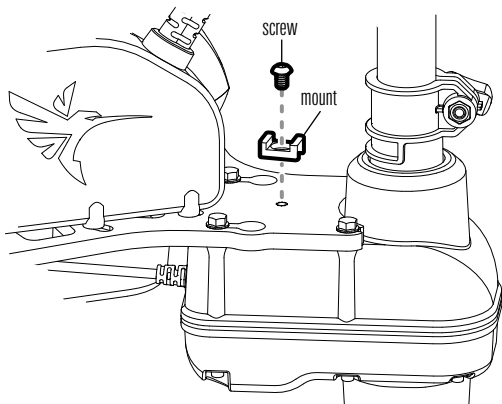

Securing the Cables to the Zip Tie Mount

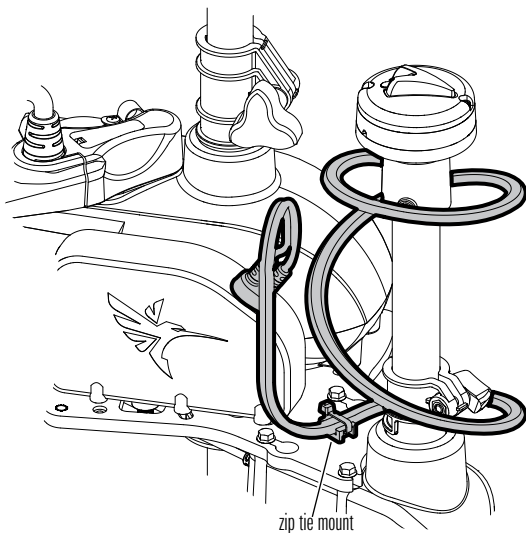

2. Route the MEGA Live TargetLock Control Box Cables

1. **If your MEGA Live TargetLock is installed on the inboard (typically starboard) side of your trolling motor:** Route the rest of the cables with your Ultrex or Ultrex QUEST trolling motor cables. Secure them with zip ties at the base of the pedal control sleeve (see illustration *Routing the Control Box Cables*) and along the trolling motor cables as needed. Route them over the bow to the chosen connection locations in *Section 1: Prepare for Installation*.

NOTE

Depending on your installation configuration, you may first need to route the cables over the trolling motor.

The included p-clip is not needed for an inboard installation.

If your MEGA Live TargetLock is installed on the outboard (typically port) side of your trolling motor: Route the cables over your trolling motor. Secure them to the trolling motor with the included p-clip and #10-24 screw. Route the rest of the cables with your Ultrex or Ultrex QUEST trolling motor cables. Secure them with zip ties at the base of the pedal control sleeve (see illustration *Routing the Control Box Cables*) and along the trolling motor cables as needed. Route them over the bow to the chosen connection locations in *Section 1: Prepare for Installation*.

CAUTION

The control box cables must be routed and secured to allow for full movement of the trolling motor during normal operation and during stow and deploy. **Failure to do so can result in damage to the control box.** Humminbird recommends observing your trolling motor as it deploys and stows before finalizing your cable routing.

Routing the Control Box Cables

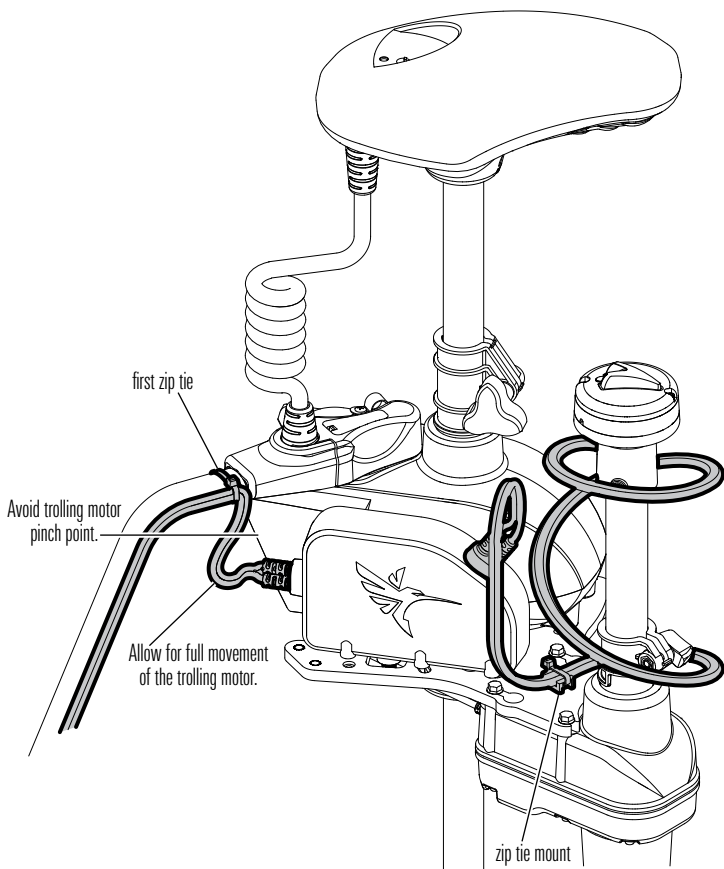

Inboard (Typically Starboard) Installation

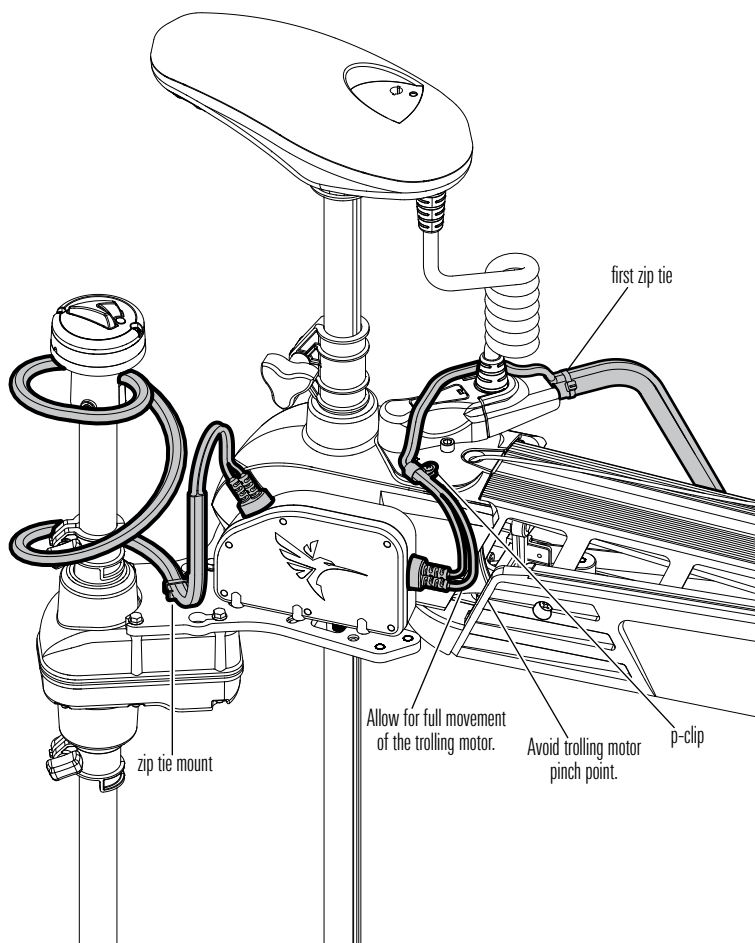

Outboard (Typically Port) Installation

2. **Ethernet:** Insert the Ethernet Cable into the Ethernet port on the fish finder. Hand-tighten the screw nut.

3. Route the MEGA 360 Cables

(separate purchase)

1. Connect the power cable to the power cable connector on the pod shaft, and connect the transducer cable to the transducer cable connector on the pod shaft.

The connectors are keyed to prevent reversed installation, so be careful not to force the connectors. Hand-tighten the screw nuts on each connector.

NOTE

If you are connecting the MEGA 360 Imaging transducer and another compatible transducer to the same fish finder, you will need to purchase a transducer splitter cable (y-cable). See **Compatibility** for the list of cables, and visit our Web site at www.humminbird.johnsonoutdoors.com/support/installation-diagrams to view the wiring diagrams.

2. Route the cables to the side of the trolling motor, over the bow, to the chosen connection locations in **Section 1: Prepare for Installation**. Leave sufficient slack in the cables to allow for full movement of the trolling motor during normal operation.
3. Insert the other end of the transducer cable to the sonar port on the fish finder. Hand-tighten the screw nut.

Sonar Port

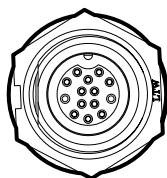

4. Connect Power

1. **Power:** Route the power cable(s) to the main switch or fuse panel (usually located near the console). If you must connect to a battery, connect to a battery switch (not included).

CAUTION

The MEGA Live TargetLock and MEGA 360 Imaging transducers should be connected to a main switch, fuse panel, or battery switch. **Humminbird does not recommend connecting to a battery without a fuse and a switch.**

Some boats have 24 or 36 Volt electric systems, but the MEGA Live 2 transducer, **MEGA Live TargetLock and MEGA 360 MUST be connected to a 12 VDC power supply.**

NOTE

Humminbird is not responsible for over-voltage or over-current failures. The MEGA Live TargetLock must have adequate protection through the proper selection and installation of a 5A slow-blow fuse.

A 10' (3 m) power cable is included to supply power to the MEGA Live TargetLock. You may shorten or lengthen the cable using 12 gauge multi-stranded copper wire.

- 2a. **Main Switch/Fuse Panel:** If a fuse terminal is available, use crimp-on type electrical connectors (not included) that match the terminal on the fuse panel. Attach the black wire to ground (–), and the red wire to positive (+) 12 VDC power, and the drain/shield wire to the boat's chassis ground terminal.

MEGA Live TargetLock: Install a 5A slow-blow fuse (not included) for protection of the unit.

MEGA 360: Install a 1 Amp fuse (not included) for protection of the unit.

OR

- 2b. **Battery Switch:** Install the battery switch (not included) using the instructions provided with it.

MEGA Live TargetLock: Install an inline fuse holder and a 5A slow-blow fuse (not included) for protection of the unit.

MEGA 360: Install an inline fuse holder and a 1 Amp fuse (not included) for protection of the unit.

Attach the black wire to ground (–), the red wire to positive (+) 12 VDC power, and the drain/shield wire to the boat's chassis ground terminal.

Connecting to the Fuse Panel

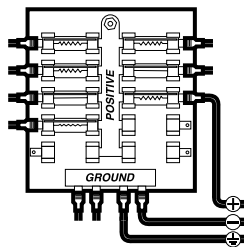

⚠ CAUTION

If you are unable to obtain a battery switch and are forced to connect the power cable directly to the battery, be aware that this will drain the battery. **Humminbird does not recommend connecting to a battery without the appropriate fuse and a switch.**

NOTE

The drain/shield wire is the non-tinned black wire.

3. Secure the cables along the route as needed for a clean assembly.

Set Up the Fish Finder

Use the following instructions to power on the fish finder and confirm the MEGA Live 2 Imaging transducer and the Humminbird GPS Heading Sensor (optional) are detected by the unit.

CAUTION





It is important to finish all installation connections before powering on the fish finder. It may take up to a minute for the MEGA Live 2 Imaging transducer and other attached equipment to be detected by the fish finder.





NOTE

For MEGA 360 set up instructions, see the manual that was included with your transducer or visit our Web site at humminbird.johnsonoutdoors.com.

1. Confirm Connections

1. Turn on the power source from the main switch.
2. On the fish finder, press the POWER key. **If you are powering on a fish finder in a multiple-fish finder Ethernet network**, make sure your ethernet switch(es) have power and your MEGA Live TargetLock is connected to the switch.
3. From the home screen, review the status bar in the top right corner of the screen to confirm the sensor status for the MEGA Live 2 transducer and that the GPS Receiver/Heading Sensor is connected.

MEGA Live 2 Status Icon	Icon Description
	Connected/In Water/Pinging: The MEGA Live 2 is connected, in the water, and pinging.
	Connected/In Water/Not Pinging: The MEGA Live 2 is connected and in the water, but it is not pinging.
	Connected/Out of Water: The MEGA Live 2 is connected, but the wet indicator is out of the water.
	Connection Lost: The connection to the MEGA Live 2 was lost.

GPS Heading Sensor Icon	Icon Description
	Compass: The selected heading sensor is on and heading data is being received.
	Detected and Active: The GPS receiver is detected and a GPS fix has been obtained.
	Connected but not Detected or Active: The GPS receiver is connected, but not detected on the network or no GPS fix has been obtained.
	Connected but not Transmitting/Receiving: The GPS receiver is detected, but it doesn't have a GPS fix.

NOTE

For additional system status, select Home > Settings > System > Network Info.

MEGA Live 2 Transducer Connected

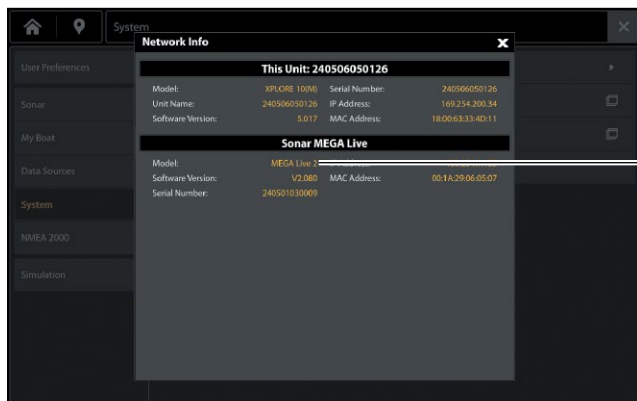

MEGA Live 2
listed

2. Set Up MEGA Live 2 Imaging on the Fish Finder

Your APEX, XPLORE or SOLIX fish finder will automatically detect and subscribe to MEGA Live 2 Imaging. To review the selected sonar sources, open the XPress menu and select Settings > MEGA Live 2 Source.

Reviewing Sonar Sources

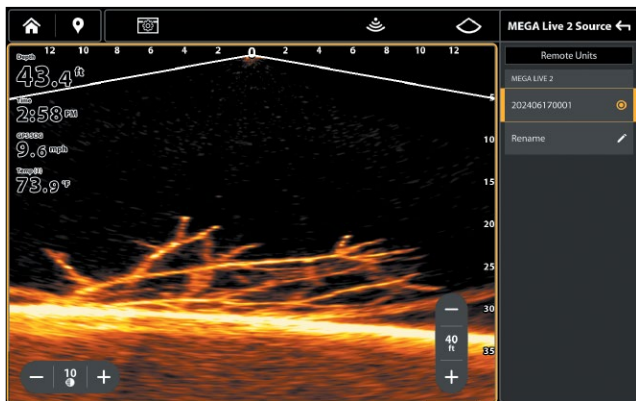

3. Test MEGA Live 2 Imaging on the Fish Finder

It is important to confirm that the MEGA Live 2 Imaging transducer is providing sonar returns to the display. The instructions in this section should be performed at trolling speeds in calm, open water, in a large area that is far from shallow water, boats, or other obstacles.

1. From the Home screen, tap the View icon in the menu tray.

NOTE

Once the MEGA Live 2 Imaging has been detected the first time, the MEGA Live 2 view will display on the Favorite Views widget.

2. Tap MEGA Live 2 and select your preferred MEGA Live 2 view.
3. The sonar returns from the MEGA Live 2 will begin to display on the MEGA Live 2 View. Review the display for the following information and see the illustrations *Reviewing the MEGA Live 2 View*.
 - **Bottom:** Confirm that the bottom is visible on-screen.
 - **Blocked Beams:** If the beams hit a hard surface, it will appear as bright white on the display. If the beams are blocked by any objects, move the objects if possible. You can also adjust the MEGA Live 2 Range on the X-Press Menu to see more or less detail on the display.
4. **Stop Pinging:** When you are finished reviewing the operation, tap the Ping icon  from the MEGA Live 2 top bar.

Ping on: 

Ping off: 

Reviewing the MEGA Live 2 View

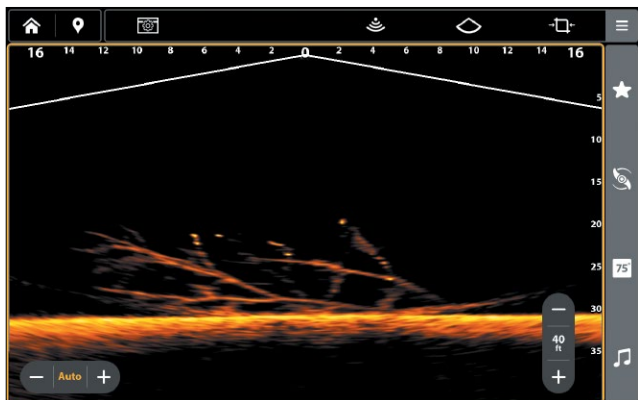

(Down)

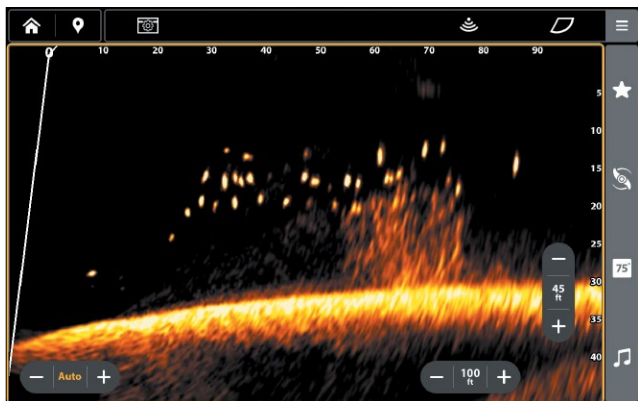

(Forward)

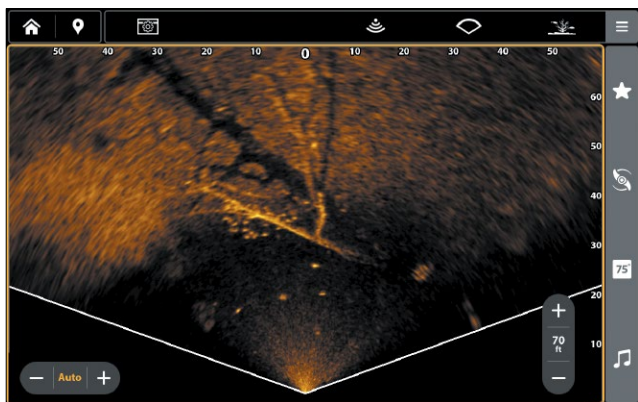

(Landscape)

Changing the MEGA Live 2 Mode

Your fish finder will automatically select the best mode for your installation. Use the following instructions to manually change the MEGA Live 2 Mode to Down, Forward, or Landscape.

1. With a MEGA Live 2 View displayed on-screen, tap the MEGA Live 2 Mode icon in the top bar.
2. Tap Auto, or use the Cursor pad and Enter key, to turn Auto off.
3. Tap, or use the Cursor pad and Enter key, to select a MEGA Live 2 Mode.

Down Mode: 

Forward Mode: 

Landscape Mode: 

When you manually change the MEGA Live 2 Mode, a message box will display reminding you to also change the transducer's installation orientation. For instructions on changing the installation orientation, see Step 2 of *Install the MEGA Live 2 Imaging TargetLock, Section 6: Test the MEGA Live 2 Views*.

Changing the MEGA Live 2 Mode

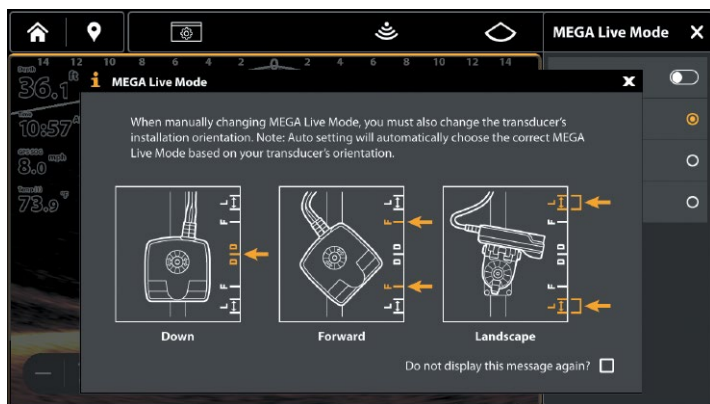

4. Pair the TargetLock Heading Sensor to the Fish Finder

Use the following instructions to pair the MEGA Live TargetLock Heading Sensor to your Humminbird fish finder.

1. Press the HOME key.
2. Select Settings.
3. Select Sonar > TargetLock.
4. Select Pair Heading Sensor.
5. On your TargetLock Heading Sensor, press the Pair button.
6. The fish finder and the TargetLock Heading Sensor will go into Pairing Mode.

If 30 seconds pass while in Pairing Mode and they do not successfully pair, an error message will display signaling that the pairing has timed out. Repeat the procedure.

5. Calibrate Your MEGA Live TargetLock Heading Sensor

Use the following instructions to calibrate your MEGA Live TargetLock Heading Sensor. Before beginning calibration, your fish finder must be paired with your TargetLock Heading Sensor and your MEGA Live 2 Imaging transducer must be in the water and connected to your fish finder.

NOTE

Your transducer will rotate during calibration. Ensure that your transducer cables can move freely before beginning this procedure. Your transducer will return to its original position when calibration is complete.

1. Press the HOME key.
2. Select Settings.
3. Select Sonar > TargetLock.
4. Select Calibrate Heading Sensor.
5. Your MEGA Live TargetLock will begin calibration. A message will display on your fish finder when calibration is complete.

6. Pair the Foot Pedal to the Fish Finder

Use the following instructions to pair the wireless foot pedal to the Humminbird fish finder.

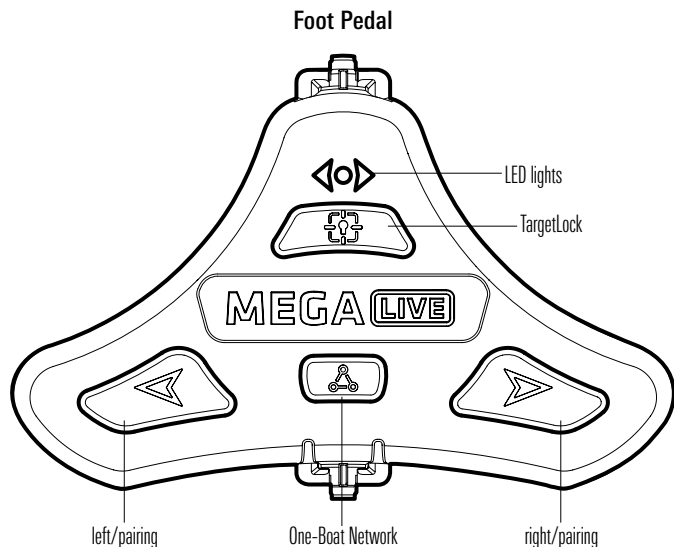

1. Press the HOME key.
2. Select Settings.
3. Select Sonar > TargetLock.
4. Select Pair Foot Pedal.
5. On your foot pedal, press and hold the Left button and the Right button at the same time until the LEDs at the top of the pedal begin to scroll. Then release the buttons.
6. The fish finder and the foot pedal will go into Pairing Mode.

If 30 seconds pass while in Pairing Mode and they do not successfully pair, an error message will display signaling that the pairing has timed out. Repeat the procedure.

NOTE

After pairing completes, if the lights on the foot pedal blink in a scrolling pattern, this indicates that the fish finder is updating the foot pedal. When the software update is complete, the pairing process will need to be repeated.

7. Pair the TargetLock Remote to the Fish Finder

Use the following instructions to pair the MEGA Live TargetLock remote to the Humminbird fish finder.

1. Press the HOME key.
2. Select Settings.
3. Select Sonar > TargetLock.
4. Select Pair Remote.
5. On your remote, press and hold the LEFT and RIGHT ARROW keys at the same time until the LEDs at the bottom of the remote begin to scroll. Then release the buttons.
6. The fish finder and the remote will go into Pairing Mode.

If 30 seconds pass while in Pairing Mode and they do not successfully pair, an error message will display on your fish finder signaling that the pairing has timed out. Repeat the procedure.

NOTE

After pairing completes, if the lights on the foot pedal blink in a scrolling pattern, this indicates that the fish finder is updating the remote. When the software update is complete, the pairing process will need to be repeated.

8. Set up the Network

After you have confirmed all connections, the MEGA Live 2 Imaging transducer is ready to use on the water. Proceed to your **MEGA Live 2 Operations Manual** to set up the GPS source, temperature source and additional sonar sources.

Power Off

⚠ CAUTION

When the boat is stored or at dock, the MEGA Live 2 Imaging transducer must be turned off to prevent draining the battery.

Power Off the Fish Finder

1. During operation, press the POWER key, and select Power Off.

⚠ CAUTION

Turning off the fish finder will NOT power off the MEGA Live 2 Imaging transducer.

2. Turn off power on the main switch, breaker, or battery switch.

Powering off the MEGA Live 2 Imaging transducer will be determined by the installation and power connection on your boat.

Stowing and Traveling with the MEGA Live 2 Transducer

The MEGA Live 2 transducer must not hit the deck, base, or any objects. This is critical during transport. Check the tension of the trolling motor bracket after initial use and periodically thereafter to ensure that the installation remains stable.

Stowing and Traveling with a 60" Shaft

Before transporting the boat, stow your motor to determine where your MEGA Live 2 transducer rests. It should rest 1 inch above the propeller when stowed (see *Stowing a 60" Shaft*). If you need to adjust the height of your transducer, use the depth collars to raise or lower it. See *Install the MEGA Live TargetLock: Adjust the Transducer Height* for more information.

Stowing a 60" Shaft

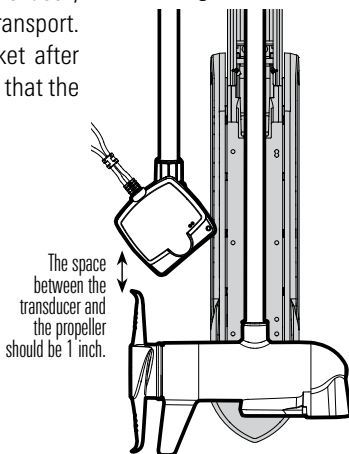

Maintenance

Your Humminbird fish finder is designed to provide years of trouble free operation with very little maintenance. Use the following procedures to ensure your Humminbird continues to deliver top performance.

Fish Finder Maintenance

It is important to consider the following precautions when using your Humminbird fish finder:

- **Chemicals**, such as those found in bug spray and sunscreen, may cause permanent damage to the fish finder screen. Such damage is not covered by the warranty.
- **NEVER leave the fish finder in a closed car or trunk.** The high temperatures generated in hot weather can damage the electronics.

Use the following information to keep the fish finder and screen clean.

- **Screen:** To clean the fish finder screen, use a mild soap (such as a nonabrasive liquid hand soap) and warm water. Wipe the screen dry with a soft cloth. Be careful to avoid scratching the screen. If water spots remain, use a solution of water and vinegar.

CAUTION

Do not use a chemical glass cleaner on the screen. Chemicals in the solution may cause cracking in the lens of the unit.

NOTE

Do not wipe the screen while dirt or grease is on the screen.

- **Fish Finder:** If the fish finder comes into contact with salt spray, wipe the affected surfaces with a cloth dampened with fresh water.

Transducer Maintenance

Use the following information to maintain the transducer operation.

- If your boat remains in the water for long periods of time, algae and other marine growth can reduce the effectiveness of the transducer. Periodically clean the face of the transducer with a cloth dampened with fresh water.
- If your boat remains out of the water for a long period of time, it may take some time to wet the transducer when it is returned to the water. Small air bubbles can climb to the surface of the transducer and interfere with proper operation. These bubbles dissipate with time, or you can wipe the face of the transducer with your fingers after the transducer is in the water.

MEGA Live 2 Imaging Maintenance

Use the following information to maintain the installation of the MEGA Live 2 Imaging Transducer.

- Check the stability of the trolling motor mount after initial use and periodically thereafter to ensure that the installation remains stable.
- If your boat will be in long-term storage, remove the MEGA Live 2 Imaging transducer and store it in -40°F to 158°F (-40°C to 70°C), dry conditions.

Replace the Foot Pedal Battery

WARNING

THIS PRODUCT CONTAINS A BUTTON BATTERY. If swallowed, a lithium button battery can cause severe or fatal injuries within 2 hours. Keep batteries out of reach of children. If you think batteries may have been swallowed or placed inside any part of the body, seek immediate medical attention.

1. With the back of the Foot Pedal facing you, use a large coin to rotate the Battery Cover counterclockwise until the Battery Cover loosens and cannot be turned any further counterclockwise.
2. Remove the Battery Cover and the old battery. Replace the battery with a new CR2450 coin cell battery. Note the proper polarity of the battery.

NOTE

The replacement battery must be a model CR2450 coin cell type. It is strongly recommended that a high quality battery is used. The positive (+) of the battery should be facing towards the Battery Cover.

3. Ensure the rubber O-ring is properly seated in the underside of the Battery Cover.
4. Replace the Battery Cover by aligning either of the Unlock icons with the Tabs, and pressing the cover down.
5. Rotate the Battery Cover clockwise using the large coin until the Lock Icon aligns with the Tabs. Tighten the Battery Cover to 0.7 Nm.

Foot Pedal Battery Cover

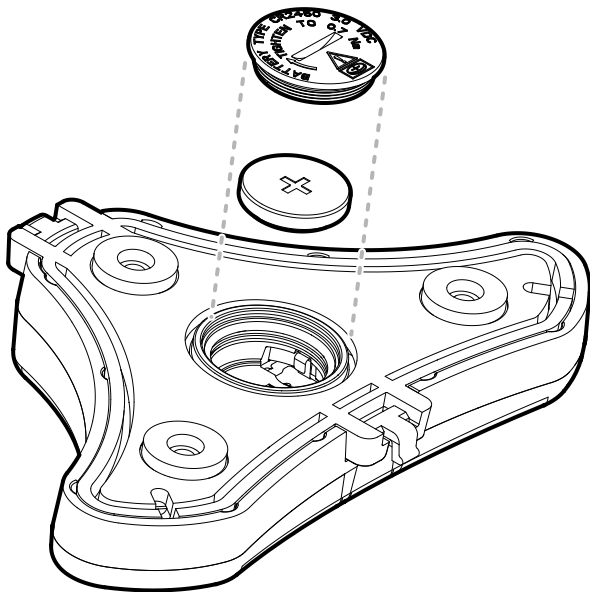

Replace the Remote Battery

If you have an optional MEGA Live TargetLock Remote, use the following instructions to change the battery.

WARNING

THIS PRODUCT CONTAINS A BUTTON BATTERY. If swallowed, a lithium button battery can cause severe or fatal injuries within 2 hours. Keep batteries out of reach of children. If you think batteries may have been swallowed or placed inside any part of the body, seek immediate medical attention.

1. With the back of the Remote facing you, use a large coin to rotate the Battery Cover counterclockwise until the Battery Cover loosens and cannot be turned any further counterclockwise.
2. Remove the Battery Cover and the old battery. Replace the battery with a new CR2450 coin cell battery. Note the proper polarity of the battery.

NOTE

The replacement battery must be a model CR2450 coin cell type. It is strongly recommended a high quality battery is used. The positive (+) of the battery should be facing towards the Battery Cover.

3. Ensure the rubber O-ring is properly seated in the underside of the Battery Cover.
4. Replace the Battery Cover by aligning either of the Unlock icons with the Tabs, and pressing the cover down.
5. Rotate the Battery Cover clockwise using the large coin until the Lock Icon aligns with the Tabs. Tighten the Battery Cover to 0.7 Nm.

Remote Battery Cover

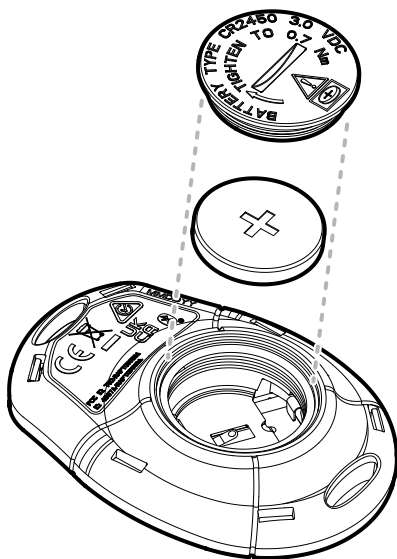

Troubleshooting

Before contacting Humminbird Technical Support, please read the following section. Taking the time to review these troubleshooting guidelines may allow you to solve a performance problem yourself, and therefore avoid sending your unit back for repair.

Fishing System Doesn't Power Up

If your Fishing System doesn't power up, use the installation guide that is included with your Fishing System to confirm specific details, making sure that:

- the power cable is properly connected to the Fishing System fish finder,
- the power cable is wired correctly, with red to positive battery terminal and black to negative terminal or ground, and the drain/shield wire to the boat's chassis ground terminal,
- the fuse is operational, and
- the battery voltage of the power connector is at least 12 Volts.

Correct any known problems, including removing corrosion from the battery terminals or wiring, or actually replacing the battery if necessary.

Finding the Cause of Noise

Electrical noise usually affects the display with streaks or repetitive patterns on the view. One or more of the following sources can cause noise or interference:

Possible Source of Noise	Isolation
Other electronic devices	Turn off any nearby electronic devices to see if the problem goes away, then turn them on one at a time to see if the noise re-appears.
Other sonar devices	Turn off any nearby sonar devices to see if the problem goes away, then turn them on one at a time to see if the noise re-appears.
The boat's engine	To determine whether the boat's engine is the source of the noise, increase the RPMs while the boat is in neutral and stationary to see if the noise increases proportionately; if noise appears when you rev the engine, the problem could be the spark plugs, alternator, or tachometer wiring. Replace the spark plugs with resistor plugs, install an alternator filter, or route the fish finder power and transducer cables away from the engine wiring.

Specifications

Operating Frequency.....	1.05 CHIRP MHz
Power Requirement.....	10 to 20 VDC
Current Draw	1.15 A maximum
Operating Temperature.....	32°F to 158°F (0°C to 70°C)
Storage Temperature	-31°F to 185°F (-35°C to 85°C)

NOTE
Humminbird verifies maximum stated depth in saltwater conditions, but actual depth performance may vary due to transducer installation, water type, thermal layers, bottom composition and slope.
Product specifications and features are subject to change without notice.

ROHS STATEMENT: Product designed and intended as a fixed installation or part of a system in a vessel may be considered beyond the scope of Directive 2002/95/EC of the European Parliament and of the Council of 27 January 2003 on the restriction of the use of certain hazardous substances in electrical and electronic equipment.

ENVIRONMENTAL COMPLIANCE STATEMENT: It is the intention of Johnson Outdoors Marine Electronics, Inc. to be a responsible corporate citizen, operating in compliance with known and applicable environmental regulations, and a good neighbor in the communities where we make or sell our products.

WEEE DIRECTIVE: EU Directive 2002/96/EC “Waste of Electrical and Electronic Equipment Directive (WEEE)” impacts most distributors, sellers, and manufacturers of consumer electronics in the European Union. The WEEE Directive requires the producer of consumer electronics to take responsibility for the management of waste from their products to achieve environmentally responsible disposal during the product life cycle.

WEEE compliance may not be required in your location for electrical & electronic equipment (EEE), nor may it be required for EEE designed and intended as fixed or temporary installation in transportation vehicles such as automobiles, aircraft, and boats. In some European Union member states, these vehicles are considered outside of the scope of the Directive, and EEE for those applications can be considered excluded from the WEEE Directive requirement.



This symbol (WEEE wheelie bin) on product indicates the product must not be disposed of with other household refuse. It must be disposed of and collected for recycling and recovery of waste EEE. Johnson Outdoors Marine Electronics, Inc. will mark all EEE products in accordance with the WEEE Directive. It is our goal to comply in the collection, treatment, recovery, and environmentally sound disposal of those products; however, these requirements do vary within European Union member states. For more information about where you should dispose of your waste equipment for recycling and recovery and/or your European Union member state requirements, please contact your dealer or distributor from which your product was purchased. Specifications

Contact Humminbird

Contact Humminbird Technical Support through our Help Center at <https://humminbird-help.johnsonoutdoors.com/hc/en-us> or in writing to the address below:

Humminbird Service Department
678 Humminbird Lane
Eufaula AL 36027 USA

Social Media Resources:



Facebook.com/HumminbirdElectronics



X.com (@humminbirdfish)



Instagram.com/humminbirdfishing



YouTube.com/humminbirdtv

